

Lori Epler,
Chair
Cumberland County

Roy Turner,
Vice-Chair
Cumberland County

Garland C. Hostetter,
Town of Spring Lake
Harvey Cain, Jr.,
Town of Stedman
Patricia Hall,
Town of Hope Mills
Charles C. Morris,
Town of Linden



Thomas J. Lloyd,
Director

Cecil P. Combs,
Deputy Director

Walter Clark,
Sara E. Piland,
Cumberland County

Benny Pearce,
Town of Eastover

Donovan McLaurin
Wade, Falcon, & Godwin

COUNTY of CUMBERLAND

Planning & Inspections Department

February 26, 2011

MEMORANDUM

TO: Cumberland County Joint Planning Board
Cumberland County Board of Education
Embarq
Fayetteville Public Works Commission

FROM: Jeff Barnhill, Planner I
Land Use Codes Section

SUBJECT: Monthly Report for February 2011
Subdivision & Site Development Plans

The following list of projects is submitted for your information. Please find attached a copy of the respective vicinity maps indicated by the case number and project name.

1. CASE NO: 11-012
NAME OF DEVELOPMENT: Ella McIver Property
TYPE OF REVIEW: Zero Lot Line Subdivision Review
LOCATION: 1202 & 1206 Mimosa Drive
ZONING: R10, Residential District
NUMBER OF LOTS: 1
TOTAL ACREAGE: .33 +/-
JURISDICTION: Cumberland County
STAFF APPROVAL DATE: February 7, 2011
OWNER/DEVELOPER: William McIver
2. CASE NO: 10-137
NAME OF DEVELOPMENT: Boxwell, Inc.
TYPE OF REVIEW: Site Plan Review
LOCATION: 4300 & 4310 Cumberland Road
ZONING: C1 (P) Commercial District
NUMBER OF LOTS: 1
TOTAL ACREAGE: .44 +/-
JURISDICTION: Cumberland County
STAFF APPROVAL DATE: December 22, 2010
REVISED STAFF APPROVAL: February 8, 2011
OWNER/DEVELOPER: Drew Boxwell

3. CASE NO: 11-013
NAME OF DEVELOPMENT: Johnnie & Griselda Sutton Property
TYPE OF REVIEW: Zero Lot Line Subdivision Review
LOCATION: 2789 Tom Geddie Road
ZONING: A1 Agricultural District
NUMBER OF LOTS: 2
TOTAL ACREAGE: 12.09 +/-
JURISDICTION: Eastover
STAFF APPROVAL DATE: February 10, 2011
EASTOVER COUNCIL APPROVAL DATE: February 15, 2011
OWNER/DEVELOPER: Johnnie & Griselda Sutton

4. CASE NO: 09-110
NAME OF DEVELOPMENT: Vander Civic & Community Center Property
TYPE OF REVIEW: Site Plan Review
LOCATION: east side of SR 1835(ROCK HILL ROAD), north side of SR 2000 (Sunnyside School Road).
ZONING: M2, Heavy Industrial District
NUMBER OF LOTS: 1
TOTAL ACREAGE: 5.36 +/-
JURISDICTION: Cumberland County
STAFF APPROVAL DATE: October 06, 2009
PLANNING BOARD APPROVAL DATE: February 15, 2011
OWNER/DEVELOPER: Vander Civic Center

5. CASE NO: 11-016
NAME OF DEVELOPMENT: Teresa Spell Property
TYPE OF REVIEW: Group Development Review
LOCATION: 2826 George Owen Road.
ZONING: R6A Residential District
NUMBER OF LOTS: 1
TOTAL ACREAGE: .43 +/-
JURISDICTION: Cumberland County
STAFF APPROVAL DATE: February 17, 2011
OWNER/DEVELOPER: Teresa Spell

6. CASE NO: 99-077
NAME OF DEVELOPMENT: Clayton Homes, Inc. Property
TYPE OF REVIEW: Site Plan Review
LOCATION: 3340 Gillespie Street
ZONING: C (P) Commercial District
NUMBER OF LOTS: 1
TOTAL ACREAGE: 4.23 +/-
JURISDICTION: Cumberland County
STAFF APPROVAL DATE: September 24, 2010
REVISED STAFF APPROVAL: February 21, 2011
OWNER/DEVELOPER: Clayton Homes

7. CASE NO: 10-132
NAME OF DEVELOPMENT: Cumberland Road "C" Store Property
TYPE OF REVIEW: Site Plan Review
LOCATION: North side of SR 1141(Cumberland Road), southwest of SR 1138(Applebury Lane)
ZONING: C (P), C1 (P) Commercial District
NUMBER OF LOTS: 1
TOTAL ACREAGE: 2.91 +/-
JURISDICTION: Cumberland County
STAFF APPROVAL DATE: December 06, 2010
REVISED STAFF APPROVAL: February 23, 2011
OWNER/DEVELOPER: George Biju

8. CASE NO: 11-017
NAME OF DEVELOPMENT: Troy & William Fisher Property
TYPE OF REVIEW: Zero Lot Line Subdivision Review
LOCATION: South side of SR 2042(Troy Fisher Road), north of SR 1002(Turnbull Road)
ZONING: A1 Agricultural District
NUMBER OF LOTS: 4
TOTAL ACREAGE: 129.41 +/-
JURISDICTION: Cumberland County
STAFF APPROVAL DATE: February 24, 2011
OWNER/DEVELOPER: Troy & William Fisher

9. CASE NO: 11-018
NAME OF DEVELOPMENT: Wyman Andrew Nichols, Jr. Property
TYPE OF REVIEW: Subdivision Review
LOCATION: North side of SR 1002(Turnbull Road), south of SR 2024(Bogie Island Road)
ZONING: A1 Agricultural District
NUMBER OF LOTS: 1
TOTAL ACREAGE: 2.02 +/-
JURISDICTION: Cumberland County
STAFF APPROVAL DATE: February 24, 2011
OWNER/DEVELOPER: Wyman A. Nichols, Jr.

**ELLIA MCIVER PROPERTY
ZERO LOT LINE SUBDIVISION REVIEW
CASE NO. 11 - 012**

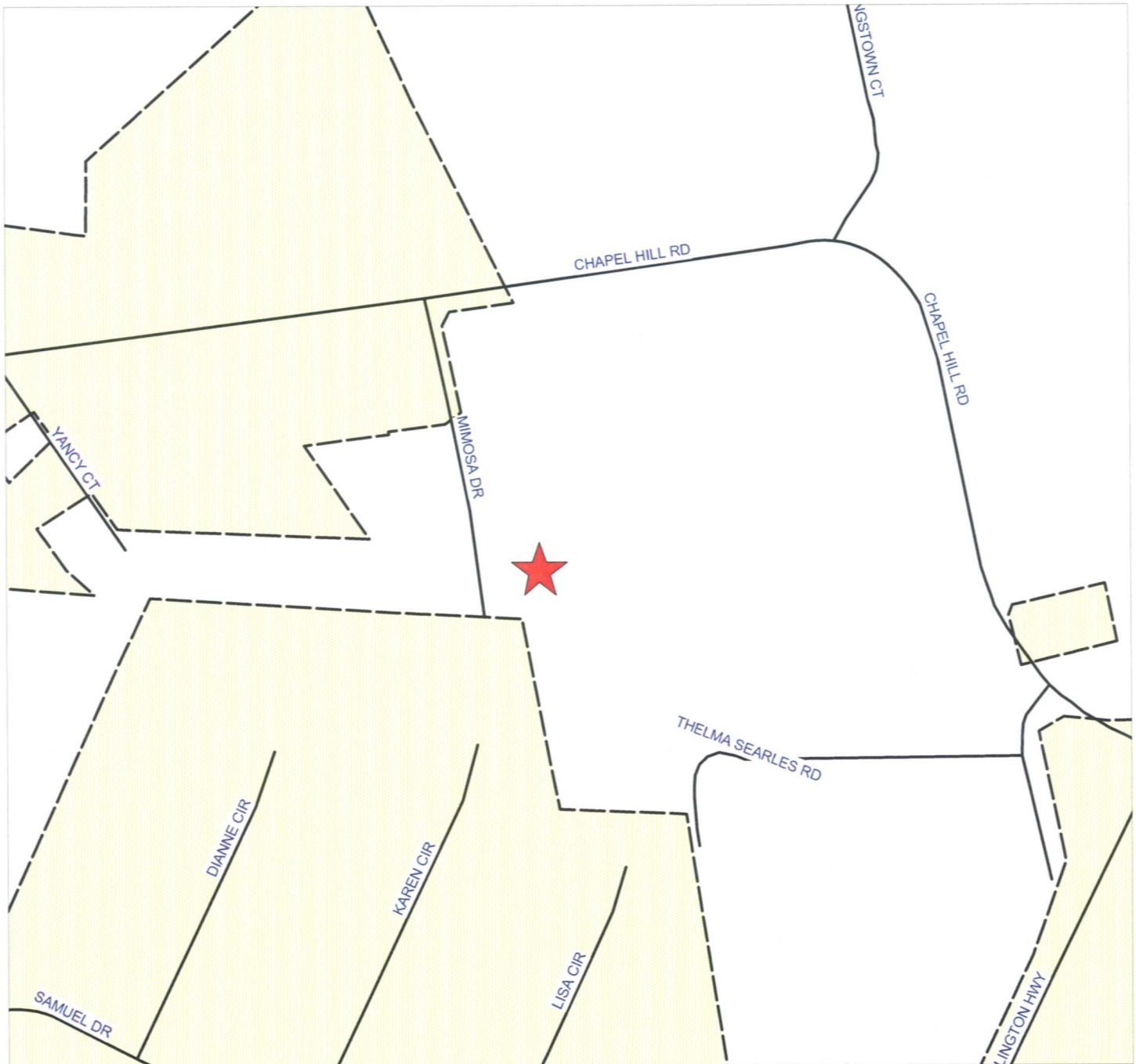

PIN(S): 0502-91-3463-
Prepared by EMB - CCJPB
JANUARY 26, 2011

Map not to scale



**BOXWELL, INC.
C1(P) SITE PLAN REVIEW
CASE NO. 10 - 137**



PIN(S): 0415-38-5693- & 0415-38-6674-
Prepared by EMB - CCJPB
DECEMBER 13, 2010

Map not to scale



**JOHNNIE J. & GRISELDA R. SUTTON PROPERTY
ZERO LOT LINE SUBDIVISION REVIEW
CASE NO. 11 - 013**



PIN(S): 0459-94-3379-
Prepared by EMB - CCJPB
FEBRUARY 8, 2011

Map not to scale



**VANDER CIVIC ASSOCIATION PARK & COMMUNITY CENTER
M2, SITE PLAN REVIEW
CASE NO. 09 - 110**



PIN(S): 0466-16-9259-
red by GJB - CCJPB
SEPTEMBER 29, 2009

Map not to scale



**TERESA SPELL PROPERTY
GROUP DEVELOPMENT REVIEW
CASE NO. 11 - 016**

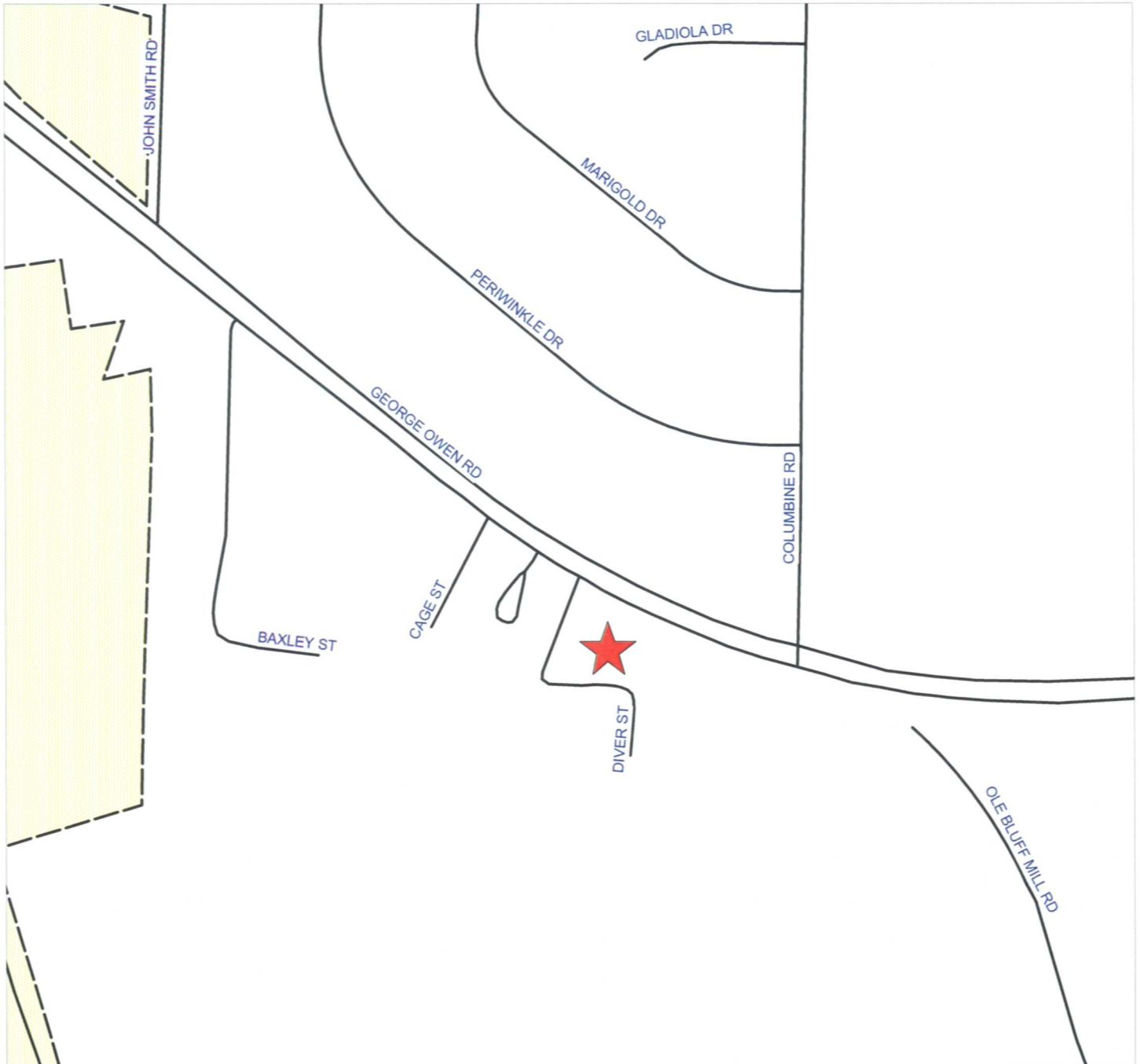

PIN(S): 0415-11-3853-
Prepared by EMB - CCJPB
FEBRUARY 9, 2011

Map not to scale



**CLAYTON HOMES PROPERTY
C (P) SITE PLAN REVIEW
CASE NO. 99-077**

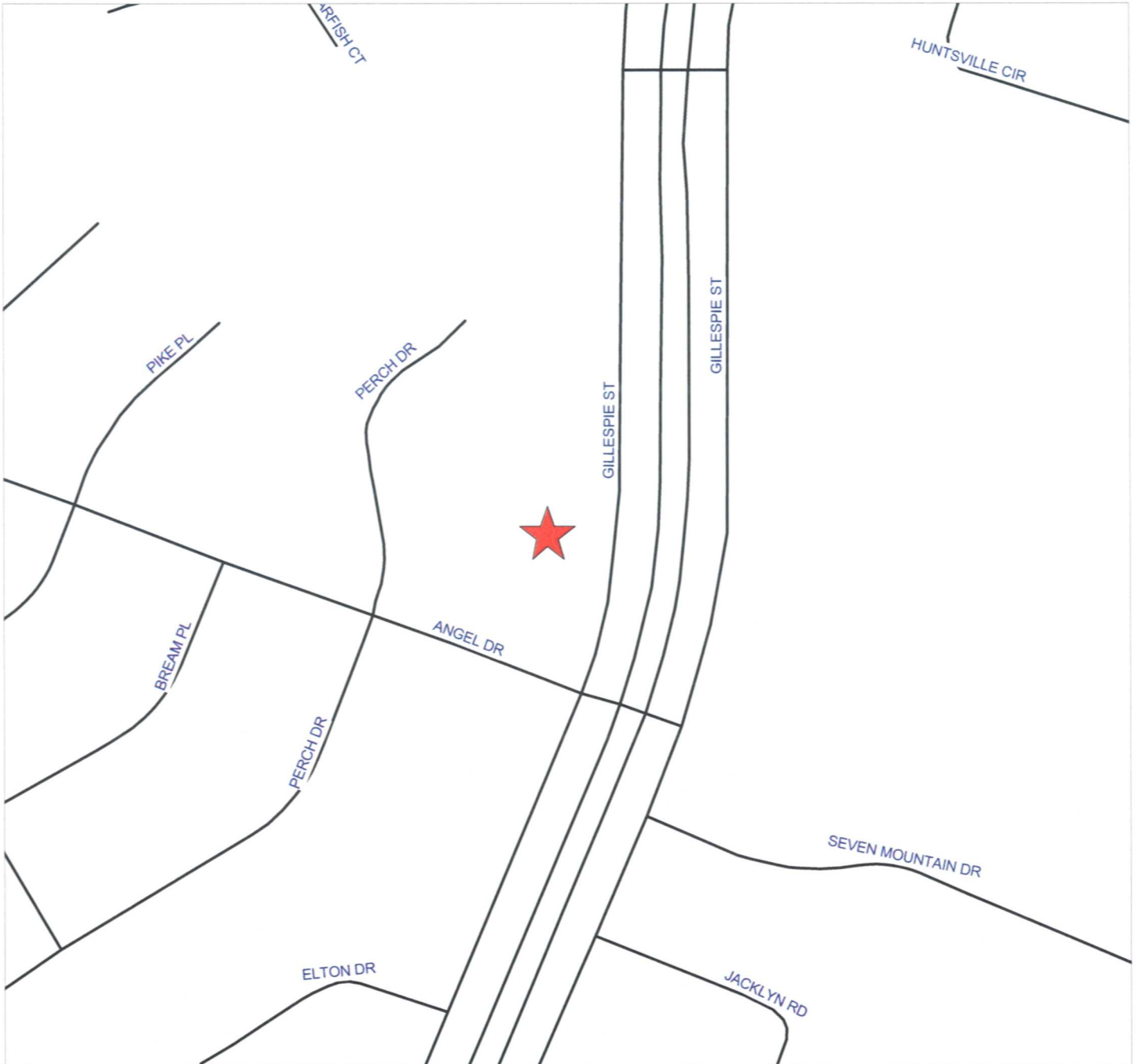

PIN(S): 0425-80-5643-
red by GJB - CCJPB
OCTOBER 1, 2010

Map not to scale



**CUMBERLAND ROAD "C" STORE
C(P) SITE PLAN REVIEW
CASE NO. 10 - 132**



PIN(S): 0405-86-5081-; 5166-; 6269-
Prepared by EMB - CCJPB
NOVEMBER 12, 2010

Map not to scale



**TROY & WILLIAM FISHER PROPERTY
SUBDIVISION REVIEW
CASE NO. 11 - 017**

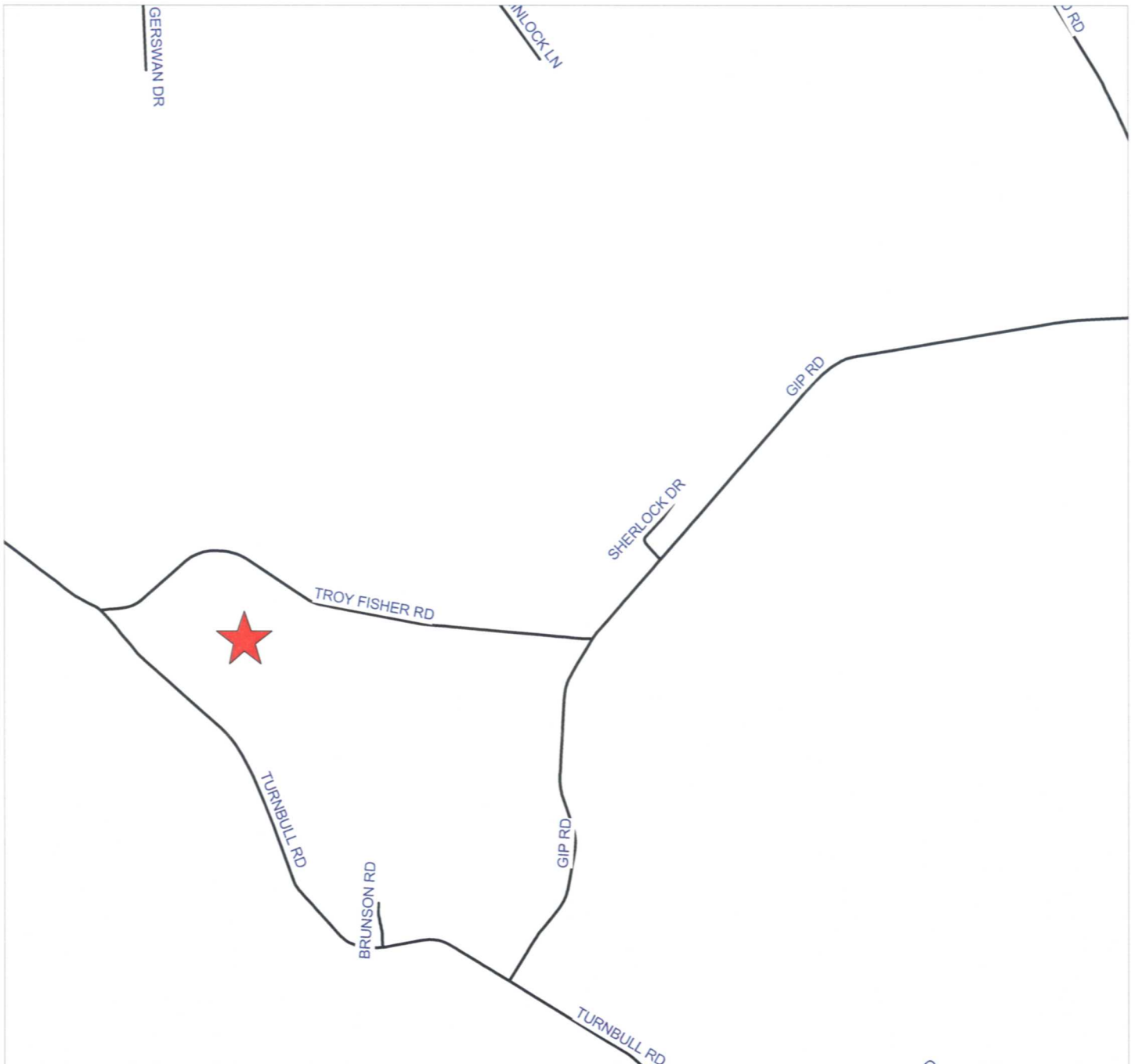

PIN(S): 0491-68-1309-
Prepared by EMB - CCJPB
FEBRUARY 10, 2011

Map not to scale



**WYMAN ANDREW NICHOLS, JR. PROPERTY
SUBDIVISION REVIEW
CASE NO. 11 - 018**

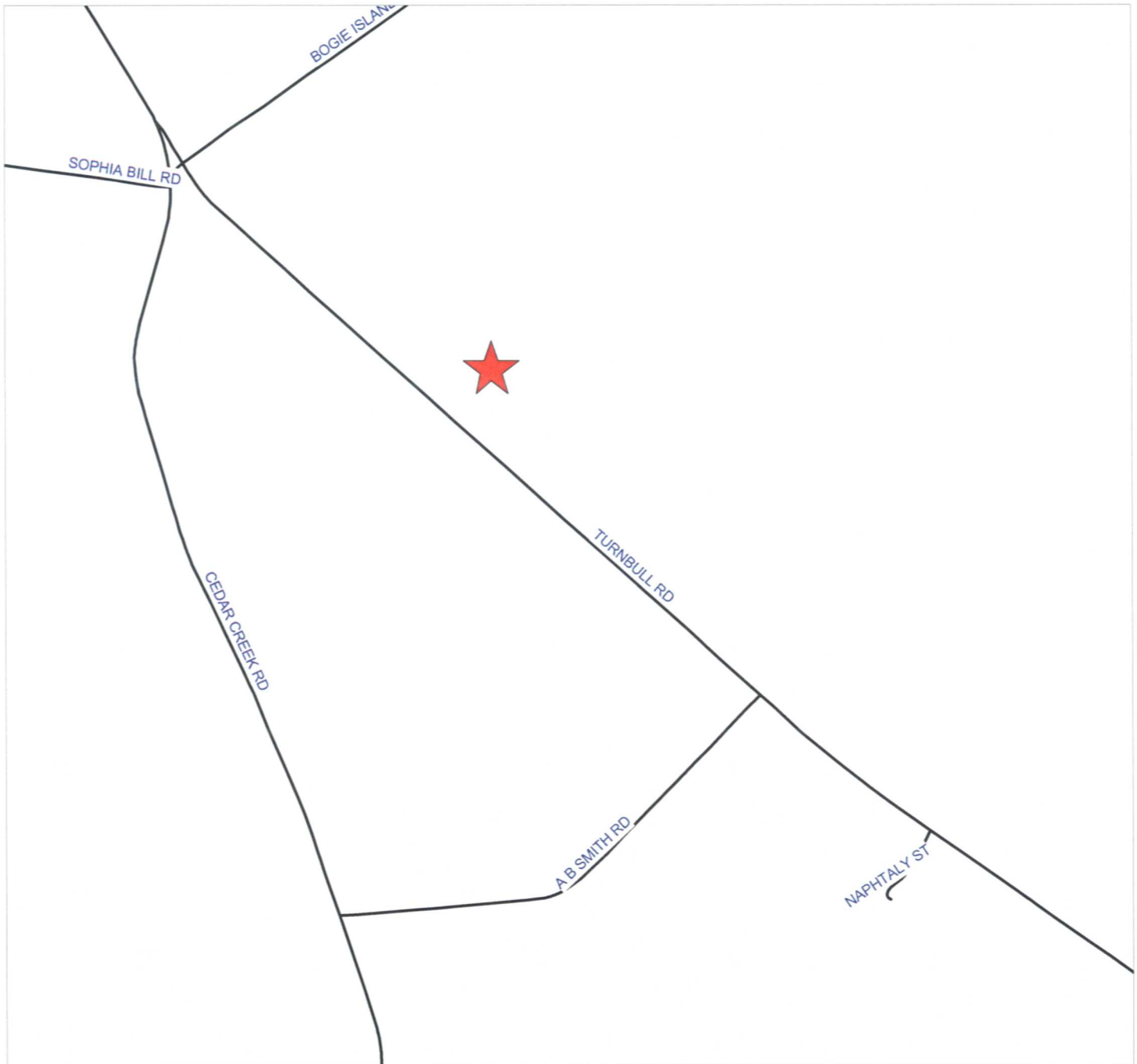

PIN(S): 0482-08-8463-
Prepared by EMB - CCJPB
FEBRUARY 11, 2011

Map not to scale

