

Lori Epler,  
Chair  
Cumberland County

Roy Turner,  
Vice-Chair  
Cumberland County

Garland C. Hostetter,  
Town of Spring Lake  
Harvey Cain, Jr.,  
Town of Stedman  
Patricia Hall,  
Town of Hope Mills  
Charles C. Morris,  
Town of Linden



Thomas J. Lloyd,  
Director

Cecil P. Combs,  
Deputy Director

Walter Clark,  
Sara E. Piland,  
Cumberland County

Benny Pearce,  
Town of Eastover

Donovan McLaurin  
Wade, Falcon, & Godwin

## COUNTY of CUMBERLAND

### *Planning & Inspections Department*

January 26, 2011

#### **MEMORANDUM**

**TO:** Cumberland County Joint Planning Board  
Cumberland County Board of Education  
Embarq  
Fayetteville Public Works Commission

**FROM:** Jeff Barnhill, Planner I  
Land Use Codes Section

**SUBJECT:** Monthly Report for January 2011  
Subdivision & Site Development Plans

The following list of projects is submitted for your information. Please find attached a copy of the respective vicinity maps indicated by the case number and project name.

1. CASE NO: 05-080  
NAME OF DEVELOPMENT: Nitta Gelatin USA, Inc. Property  
TYPE OF REVIEW: Site Plan Review  
LOCATION: 4341 Production Drive  
ZONING: M (P), Heavy Industrial District  
NUMBER OF LOTS: 1  
TOTAL ACREAGE: 37.03 +/-  
JURISDICTION: Cumberland County  
STAFF APPROVAL DATE: June 2, 2005  
REVISED STAFF APPROVAL DATE: January 13, 2011  
OWNER/DEVELOPER: Chad Kormanek – Nitta Gelatin
2. CASE NO: 11-003  
NAME OF DEVELOPMENT: Jennifer Broughton Property  
TYPE OF REVIEW: Group Development Review  
LOCATION: 2506 Smith Road  
ZONING: RR, Residential District  
NUMBER OF LOTS: 1  
TOTAL ACREAGE: .56 +/-  
JURISDICTION: Cumberland County  
STAFF APPROVAL DATE: January 14, 2011  
OWNER/DEVELOPER: Catherine Cain

3. CASE NO: 10-139

NAME OF DEVELOPMENT: Cumberland Crossing Property  
TYPE OF REVIEW: Zero Lot Line Subdivision & Site Plan Review  
LOCATION: North side of SR 1141(Cumberland Road), east side of SR 1219(Ireland Drive)  
ZONING: C3, Commercial District  
NUMBER OF LOTS: 1  
TOTAL ACREAGE: 1.43 +/-  
JURISDICTION: Cumberland County  
STAFF APPROVAL DATE: January 20, 2011  
OWNER/DEVELOPER: Joseph Riddle

4. CASE NO: 11-004

NAME OF DEVELOPMENT: Margaret W. Kimbel, Heirs Property  
TYPE OF REVIEW: Subdivision Review  
LOCATION: 1828 & 1830 Middle Road  
ZONING: RR & A1, Agricultural & Residential Districts  
NUMBER OF LOTS: 2  
TOTAL ACREAGE: 8.26 +/-  
JURISDICTION: Eastover  
STAFF APPROVAL DATE: January 20, 2011  
OWNER/DEVELOPER: David Kimbel

5. CASE NO: 11-005

NAME OF DEVELOPMENT: Jefferson Landing  
TYPE OF REVIEW: Zero Lot Line Subdivision Review  
LOCATION: North side of SR 2257(County Line Road), west side of SR 2397(Governors Lane)  
ZONING: A1 & R40 Agricultural & Residential District  
NUMBER OF LOTS: 8  
TOTAL ACREAGE: 49.74 +/-  
JURISDICTION: Cumberland County  
STAFF APPROVAL DATE: January 21, 2011  
OWNER/DEVELOPER: KBR – 2 Investments, LLC.

6. CASE NO: 10-117

NAME OF DEVELOPMENT: Upchurch Plantation  
TYPE OF REVIEW: Zero Lot Line Subdivision Review  
LOCATION: Northeast intersection of SR 1115 Black Bridge Road and SR 1116(Lake Upchurch Road)  
ZONING: RR, Residential District  
NUMBER OF LOTS: 90  
TOTAL ACREAGE: 46.35 +/-  
JURISDICTION: Cumberland County  
STAFF APPROVAL DATE: January 21, 2011  
OWNER/DEVELOPER: Terry Spell Land Development, LLC.

7. CASE NO: 08-180

NAME OF DEVELOPMENT: Black Bridge Convenience Store

TYPE OF REVIEW: Subdivision & Site Plan Review

LOCATION: West side of SR 1115 (Black Bridge Road), north of Heddingham Drive

ZONING: C1 (P), Commercial District

NUMBER OF LOTS: 1

TOTAL ACREAGE: 4.36 +/-

JURISDICTION: Hope Mills

REVISED STAFF APPROVAL DATE: January 24, 2011

HOPE MILLS COMMISSIONER'S APPROVAL DATE: July 7, 2009

OWNER/DEVELOPER: Biju George

8. CASE NO: 10-042

NAME OF DEVELOPMENT: CVS/Pharmacy # 6633

TYPE OF REVIEW: Zero Lot Line Subdivision & Site Plan Review

LOCATION: North side of SR 1112 (Rockfish Road), east side of SR 1108(Lakewood Drive)

ZONING: C2 (P) & MXD/CUD, Commercial & Mixed, Conditional Use District

NUMBER OF LOTS: 1

TOTAL ACREAGE: 36.0 +/-

JURISDICTION: Cumberland County

STAFF APPROVAL DATE: June 17, 2010

REVISED STAFF APPROVAL DATE: January 25, 2011

OWNER/DEVELOPER: Redd Realty

# NITTA GELATIN USA INC. M(P) SITE PLAN REVIEW

CASE NO. 05-080



PIN: 0433-45-4116  
PREPARED BY ARN - CCJPB  
MAY 19, 2005

Map not to scale



**JENNIFER BROUGHTON PROPERTY  
GROUP DEVELOPMENT REVIEW  
CASE NO. 11 - 003**

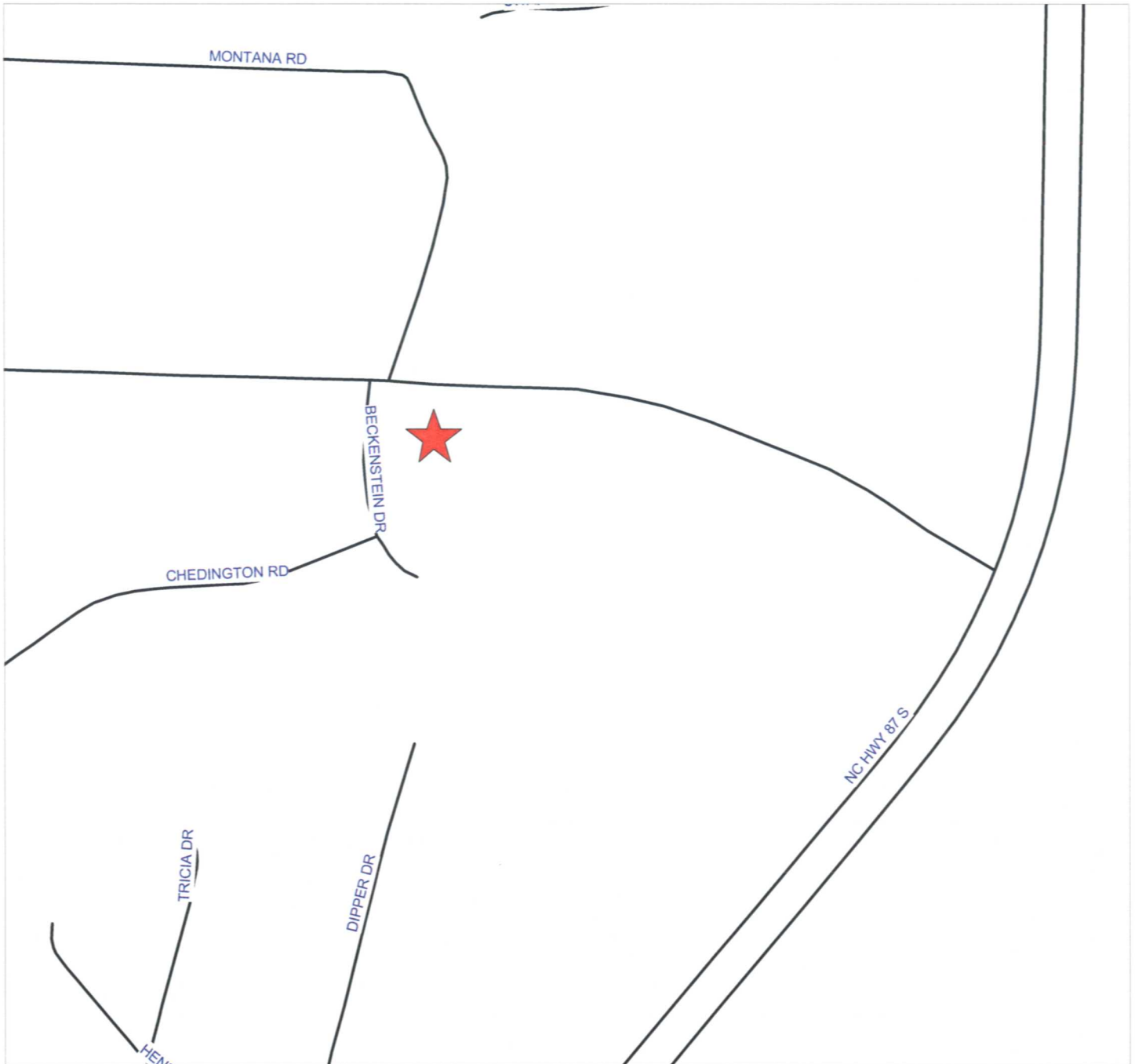

PIN(S): 0443-42-2095-  
Prepared by EMB - CCJPB  
FEBRUARY 8, 2011

Map not to scale





**CUMBERLAND CROSSING PROPERTY  
C3 SITE PLAN & ZERO LOT LINE SUBDIVISION REVIEW  
CASE NO. 10 - 139**

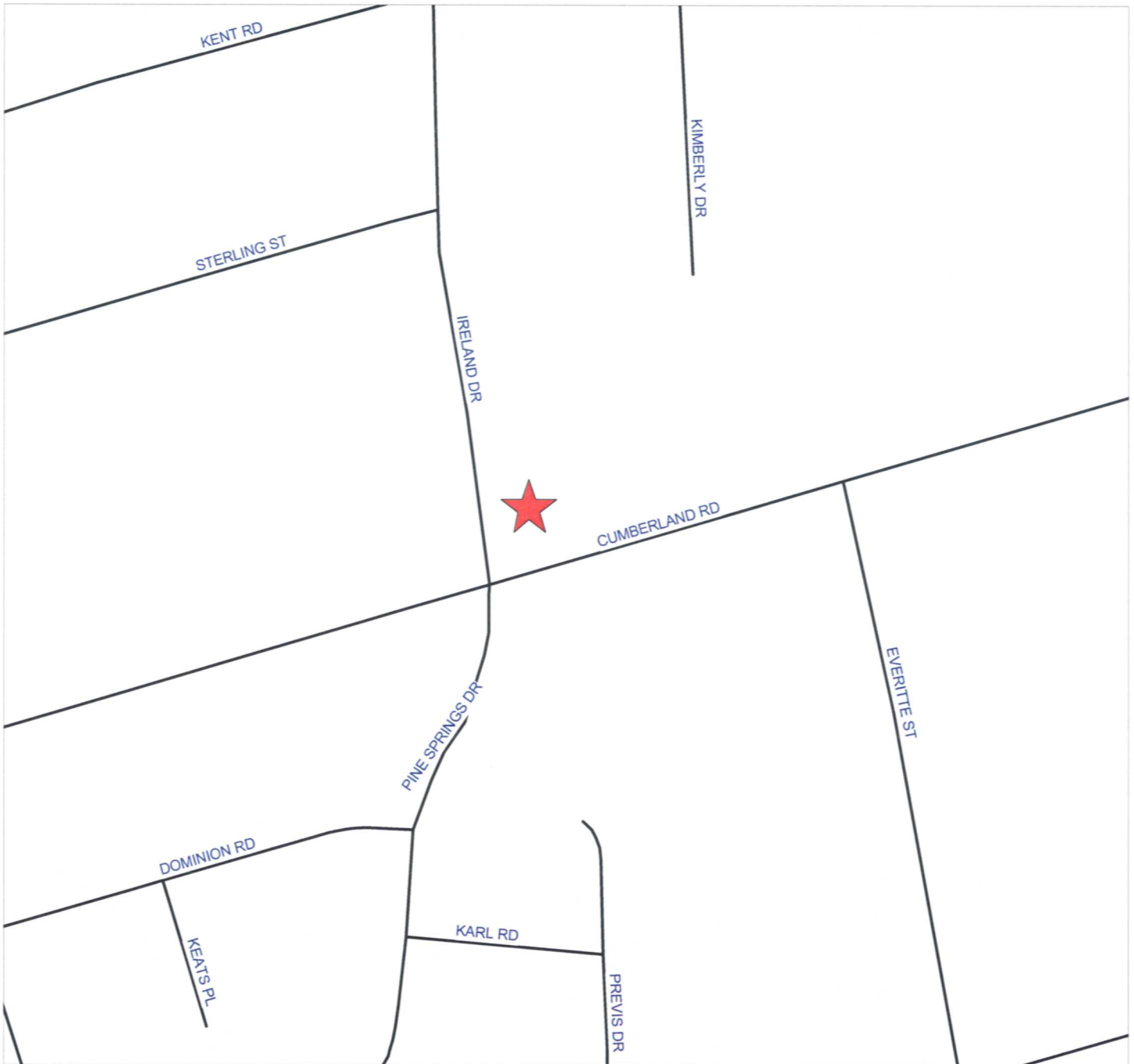

PIN(S): 0415-89-19850-  
Prepared by EMB - CCJPB  
DECEMBER 15, 2010

Map not to scale



**MARGARET W. KIMBEL, HEIRS PROPERTY  
SUBDIVISION REVIEW  
CASE NO. 11 - 004**



PIN(S): 0458-36-7399- & 0458-36-6957-  
Prepared by EMB - CCJPB  
JANUARY 6, 2011

Map not to scale



**JEFFERSON LANDING PROPERTY  
ZERO LOT LINE SUBDIVISION REVIEW  
CASE NO. 11 - 005**

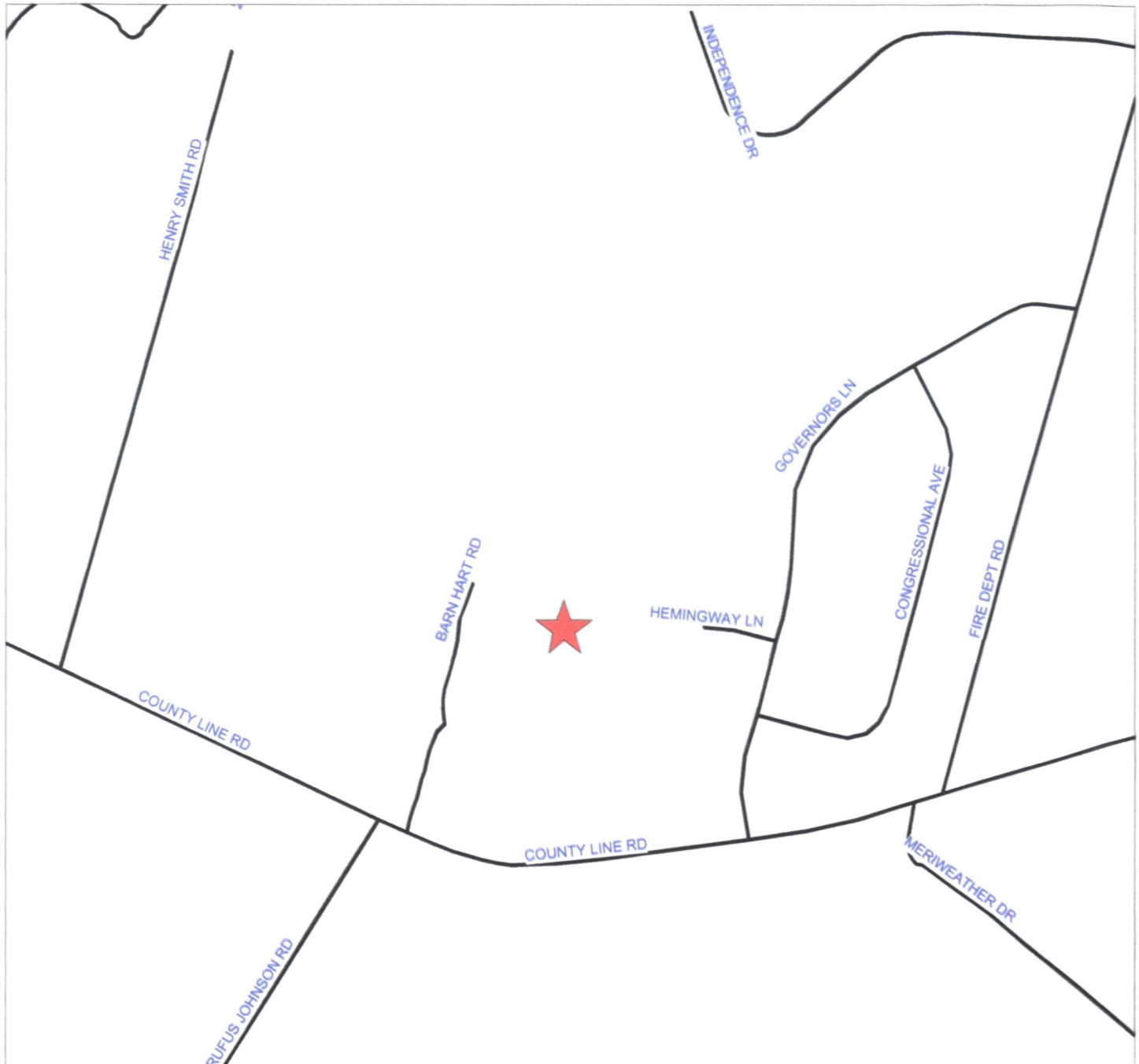

PIN(S): 0430-50-0697- & 0339-49-9549-  
Prepared by EMB - CCJPB  
JANUARY 12, 2011

Map not to scale





**UPCHURCH PLANTATION PROPERTY  
SUBDIVISION REVIEW  
CASE NO. 10 - 117**

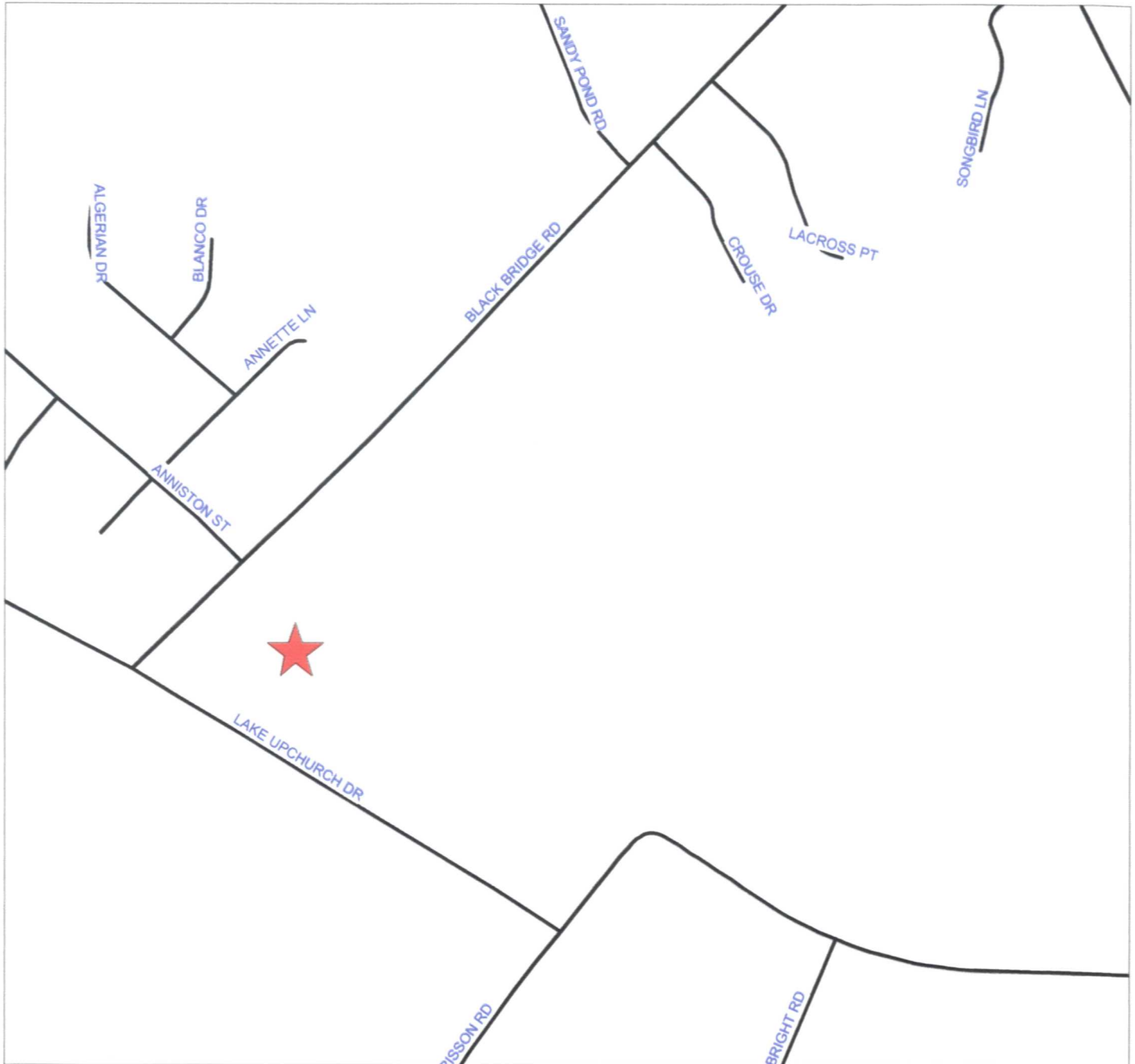

PIN(S): 0403-32-7860-  
Prepared by GJB - CCJPB  
OCTOBER 06, 2010

Map not to scale



**BLACK BRIDGE CONVENIENCE STORE  
SUBDIVISION & C1(P) SITE PLAN REVIEW  
CASE NO. 08 - 180**



PIN(S): 0404-80-0634-  
Prepared by EMB - CCJPB  
DECEMBER 22, 2008

Map not to scale



**CVS/PHARMACY #6633  
C2 (P) & MXD/CUD SITE PLAN REVIEW  
CASE NO. 10 - 042**



PIN(S): 9494-58-2359-, 9494-58-3554-, 9494-58-4227-, 9494-68-2619-  
red by GJB - CCJPB  
APRIL 12, 2010

Map not to scale

