

Walter Clark,  
Chair  
Cumberland County

Patricia Hall,  
Vice-Chair  
Town of Hope Mills

Garland C. Hostetter,  
Town of Spring Lake  
Harvey Cain, Jr.,  
Town of Stedman  
Charles C. Morris,  
Town of Linden



## COUNTY of CUMBERLAND

### *Planning & Inspections Department*

February 26, 2013

Thomas J. Lloyd,  
Director

Cecil P. Combs,  
Deputy Director

Lori Epler,  
Sara E. Piland,  
Vikki Andrews,  
Cumberland County

Benny Pearce,  
Town of Eastover

Donovan McLaurin,  
Wade, Falcon & Godwin

#### **MEMORANDUM**

**TO:** Cumberland County Joint Planning Board  
Cumberland County Board of Education  
Embarq  
Fayetteville Public Works Commission

**FROM:** Jeff Barnhill, Planner I  
Land Use Codes Section

**SUBJECT:** Monthly Report for February 2013  
Subdivision & Site Development Plans

The following list of projects is submitted for your information. Please find attached a copy of the respective vicinity maps indicated by the case number and project name.

1. CASE NO: 13-010  
NAME OF DEVELOPMENT: Cypress Lakes Village  
TYPE OF REVIEW: Zero Lot Line Subdivision Review  
LOCATION: east end of SR 3947(Celebration Drive), east of SR 2252(Chicken Foot Road)  
ZONING: R10/CU, Residential, Conditional Use District  
NUMBER OF LOTS: 267  
TOTAL ACREAGE: 319.78 +/-  
JURISDICTION: Cumberland County  
STAFF APPROVAL DATE: February 1, 2013  
OWNER/DEVELOPER: Prewitt Land Company
2. CASE NO: 01-069  
NAME OF DEVELOPMENT: The Pruitts Property  
TYPE OF REVIEW: Group Development Review  
LOCATION: 5341 Goldsboro Road (NC HWY 13)  
ZONING: A1, Agricultural District  
NUMBER OF LOTS: 1  
TOTAL ACREAGE: 42.26 +/-  
JURISDICTION: Cumberland County  
STAFF APPROVAL DATE: February 5, 2013  
OWNER/DEVELOPER: The Pruitt

3. CASE NO: 13-012  
NAME OF DEVELOPMENT: James Lawrence Property  
TYPE OF REVIEW: Subdivision Review  
LOCATION: 9712 West Reeves Bridge Road  
ZONING: A1, Agricultural District  
NUMBER OF LOTS: 2  
TOTAL ACREAGE: 17.13 +/-  
JURISDICTION: Cumberland County  
STAFF APPROVAL DATE: February 5, 2013  
OWNER/DEVELOPER: James Lawrence
  
4. CASE NO: 13-010  
NAME OF DEVELOPMENT: Cypress Lakes Village  
TYPE OF REVIEW: Zero Lot Line Subdivision Review  
LOCATION: east end of SR 3947(Celebration Drive), east of SR 2252(Chicken Foot Road)  
ZONING: R10/CU, Residential, Conditional Use District  
NUMBER OF LOTS: 267  
TOTAL ACREAGE: 319.78 +/-  
JURISDICTION: Cumberland County  
STAFF APPROVAL DATE: February 1, 2013  
STAFF REVISED APPROVAL DATE: February 5, 2013  
OWNER/DEVELOPER: Prewitt Land Company
  
5. CASE NO: 13-014  
NAME OF DEVELOPMENT: Big John's Furniture Store  
TYPE OF REVIEW: Site Plan Review  
LOCATION: 3521 Clinton Road  
ZONING: C3, Commercial District  
NUMBER OF LOTS: 1  
TOTAL ACREAGE: .36 +/-  
JURISDICTION: Cumberland County  
STAFF APPROVAL DATE: February 6, 2013  
OWNER/DEVELOPER: John Davis
  
6. CASE NO: 13-013  
NAME OF DEVELOPMENT: Kenneth Davis  
TYPE OF REVIEW: Zero Lot Line Subdivision Review  
LOCATION: 2065 Yarborough Road  
ZONING: A1, Agricultural District  
NUMBER OF LOTS: 2  
TOTAL ACREAGE: 4.00 +/-  
JURISDICTION: Cumberland County  
STAFF APPROVAL DATE: February 6, 2013  
OWNER/DEVELOPER: Kenneth Davis

7. CASE NO: 13-015  
NAME OF DEVELOPMENT: Garden Grove Park  
TYPE OF REVIEW: Manufactured Home Park Addition Review  
LOCATION: 1754 Dassie Drive  
ZONING: R6A, CD, Residential & Conservancy District  
NUMBER OF LOTS: 1  
TOTAL ACREAGE: 12.35 +/-  
JURISDICTION: Cumberland County  
STAFF APPROVAL DATE: February 7, 2013  
OWNER/DEVELOPER: Garden Grove Park
  
8. CASE NO: 13-012  
NAME OF DEVELOPMENT: James Lawrence Park  
TYPE OF REVIEW: Subdivision Review  
LOCATION: 9712 W. Reeves Bridge Road  
ZONING: A1, Agricultural District  
NUMBER OF LOTS: 2  
TOTAL ACREAGE: 17.13 +/-  
JURISDICTION: Cumberland County  
STAFF APPROVAL DATE: February 5, 2013  
REVISED STAFF APPROVAL DATE: February 8, 2013  
OWNER/DEVELOPER: George Lott
  
9. CASE NO: 13-016  
NAME OF DEVELOPMENT: Samuel Pope  
TYPE OF REVIEW: Zero Lot Line Subdivision Review  
LOCATION: 6516 Oak Grove Church Road  
ZONING: A1, Agricultural District  
NUMBER OF LOTS: 3  
TOTAL ACREAGE: 7.13 +/-  
JURISDICTION: Cumberland County  
STAFF APPROVAL DATE: February 8, 2013  
OWNER/DEVELOPER: Mike Tate
  
10. CASE NO: 13-018  
NAME OF DEVELOPMENT: Bobby Hall  
TYPE OF REVIEW: Group Development Review  
LOCATION: 9949 Norris Road  
ZONING: A1, Agricultural District  
NUMBER OF LOTS: 2  
TOTAL ACREAGE: 19.65 +/-  
JURISDICTION: Cumberland County  
STAFF APPROVAL DATE: February 13, 2013  
OWNER/DEVELOPER: Bobby Hall

11. CASE NO: 12-091  
NAME OF DEVELOPMENT: Stoney Point – Van G. Dickens  
TYPE OF REVIEW: Zero Lot Line Subdivision Review  
LOCATION: South of SR 3336(Cricket Road)  
ZONING: R10, Residential District  
NUMBER OF LOTS: 6  
TOTAL ACREAGE: 2.37 +/-  
JURISDICTION: Cumberland County  
STAFF APPROVAL DATE: July 13, 2012  
REVISED STAFF APPROVAL DATE: February 15, 2013  
OWNER/DEVELOPER: Shirley Dickens
  
12. CASE NO: 11-014  
NAME OF DEVELOPMENT: Dorothy Chilton  
TYPE OF REVIEW: Site Plan Review  
LOCATION: 3445 Gillespie Street  
ZONING: C(P), Commercial District  
NUMBER OF LOTS: 1  
TOTAL ACREAGE: 4.84 +/-  
JURISDICTION: Cumberland County  
STAFF APPROVAL DATE: May 27, 2011  
REVISED STAFF APPROVAL DATE: February 15, 2013  
OWNER/DEVELOPER: Dorothy Chilton
  
13. CASE NO: 13-017  
NAME OF DEVELOPMENT: Brian Wilson  
TYPE OF REVIEW: Subdivision Review  
LOCATION: 4258 South River School Road  
ZONING: A1, Agricultural District  
NUMBER OF LOTS: 2  
TOTAL ACREAGE: 22.27 +/-  
JURISDICTION: Cumberland County  
STAFF APPROVAL DATE: February 19, 2013  
OWNER/DEVELOPER: Brian Wilson
  
14. CASE NO: 12-100  
NAME OF DEVELOPMENT: Isaac Young Property  
TYPE OF REVIEW: Group Development Review  
LOCATION: 4458 Claude Lee Road  
ZONING: RR, Rural Residential District  
NUMBER OF UNITS: 2  
TOTAL ACREAGE: 14.07 +/-  
JURISDICTION: Cumberland County  
STAFF APPROVAL DATE: July 26, 2012  
PLANNING BOARD APPROVAL: February 19, 2013  
OWNER/DEVELOPER: Isaac Young

15. CASE NO: 12-044  
NAME OF DEVELOPMENT: New Haven Church Property  
TYPE OF REVIEW: Site Plan Review  
LOCATION: 2361 George Owen Road  
ZONING: R6A, Residential District  
NUMBER OF LOTS: 1  
TOTAL ACREAGE: .67 +/-  
JURISDICTION: Cumberland County  
STAFF APPROVAL DATE: April 3, 2012  
REVISED STAFF APPROVAL DATE: February 21, 2013  
OWNER/DEVELOPER: New Haven Church
16. CASE NO: 97-023  
NAME OF DEVELOPMENT: Starbright Investments, LLC Property  
TYPE OF REVIEW: Site Plan Review  
LOCATION: 101 Sleepy Drive  
ZONING: C (P), Commercial District  
NUMBER OF LOTS: 1  
TOTAL ACREAGE: .72 +/-  
JURISDICTION: Spring Lake  
STAFF APPROVAL DATE: February 21, 2013  
SPRING LAKE ALDERMAN APPROVAL DATE: February 25, 2013  
OWNER/DEVELOPER: Starbright Investments, LLC
17. CASE NO: 02-258  
NAME OF DEVELOPMENT: Youngs Auto Center & Salvage Property  
TYPE OF REVIEW: Site Plan Review  
LOCATION: 1307 Lillington Highway  
ZONING: M (P), Heavy Industrial District  
NUMBER OF LOTS: 1  
TOTAL ACREAGE: 11.01 +/-  
JURISDICTION: Cumberland County  
STAFF APPROVAL DATE: February 19, 2013  
OWNER/DEVELOPER: Youngs Auto Center
18. CASE NO: 12-025  
NAME OF DEVELOPMENT: Stanley Property  
TYPE OF REVIEW: Site Plan Review  
LOCATION: South side of SR 2228(Johnson Road), west of NC HWY 53(Cedar Creek Road)  
ZONING: A1, Agricultural District  
NUMBER OF LOTS: 1  
TOTAL ACREAGE: 135.90 +/-  
JURISDICTION: Cumberland County  
STAFF APPROVAL DATE: March 06, 2012  
REVISED STAFF APPROVAL DATE: February 28, 2013  
OWNER/DEVELOPER: David Stanley

19. CASE NO: 13-020

NAME OF DEVELOPMENT: Bobby & Cleo Washington Property

TYPE OF REVIEW: Subdivision Review

LOCATION: 5605 Murphy Road

ZONING: R40A, Residential District

NUMBER OF LOTS: 3

TOTAL ACREAGE: 10.34 +/-

JURISDICTION: Cumberland County

STAFF APPROVAL DATE: February 27, 2013

OWNER/DEVELOPER: Bobby Washington

**CYPRESS LAKES VILLAGE PROPERTY  
ZERO LOT LINE SUBDIVISION REVIEW  
CASE NO. 13-010**

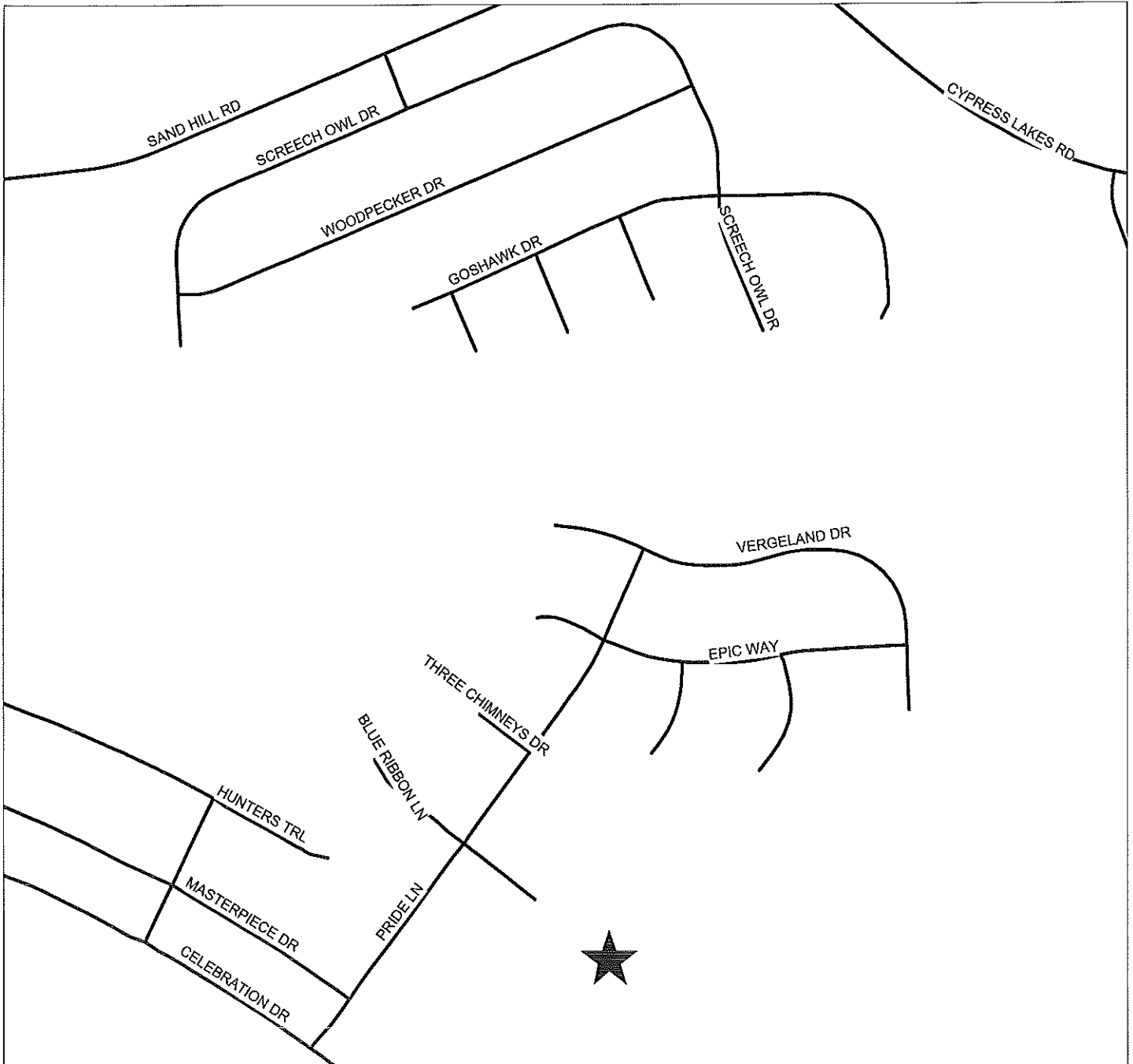

PIN(S): 0432-25-3989-  
red by GJB - CCJPB  
FEBRUARY 28, 2013

Map not to scale



**K. D. PRUITT  
GROUP DEVELOPMENT REVIEW**

**CASE NO. 01-069**



PIN: 0580.01-61-7144-  
PREPARED BY E. M. B. - CCJPB  
MARCH 28, 2001

Map not to scale



**JAMES LAWRENCE TAYLOR PROPERTY  
SUBDIVISION REVIEW  
CASE NO. 13-012**



PIN(S): 0554-44-1286-  
red by GJB - CCJPB  
JANUARY 29, 2013

Map not to scale



**CYPRESS LAKES VILLAGE PROPERTY  
ZERO LOT LINE SUBDIVISION REVIEW  
CASE NO. 13-010**

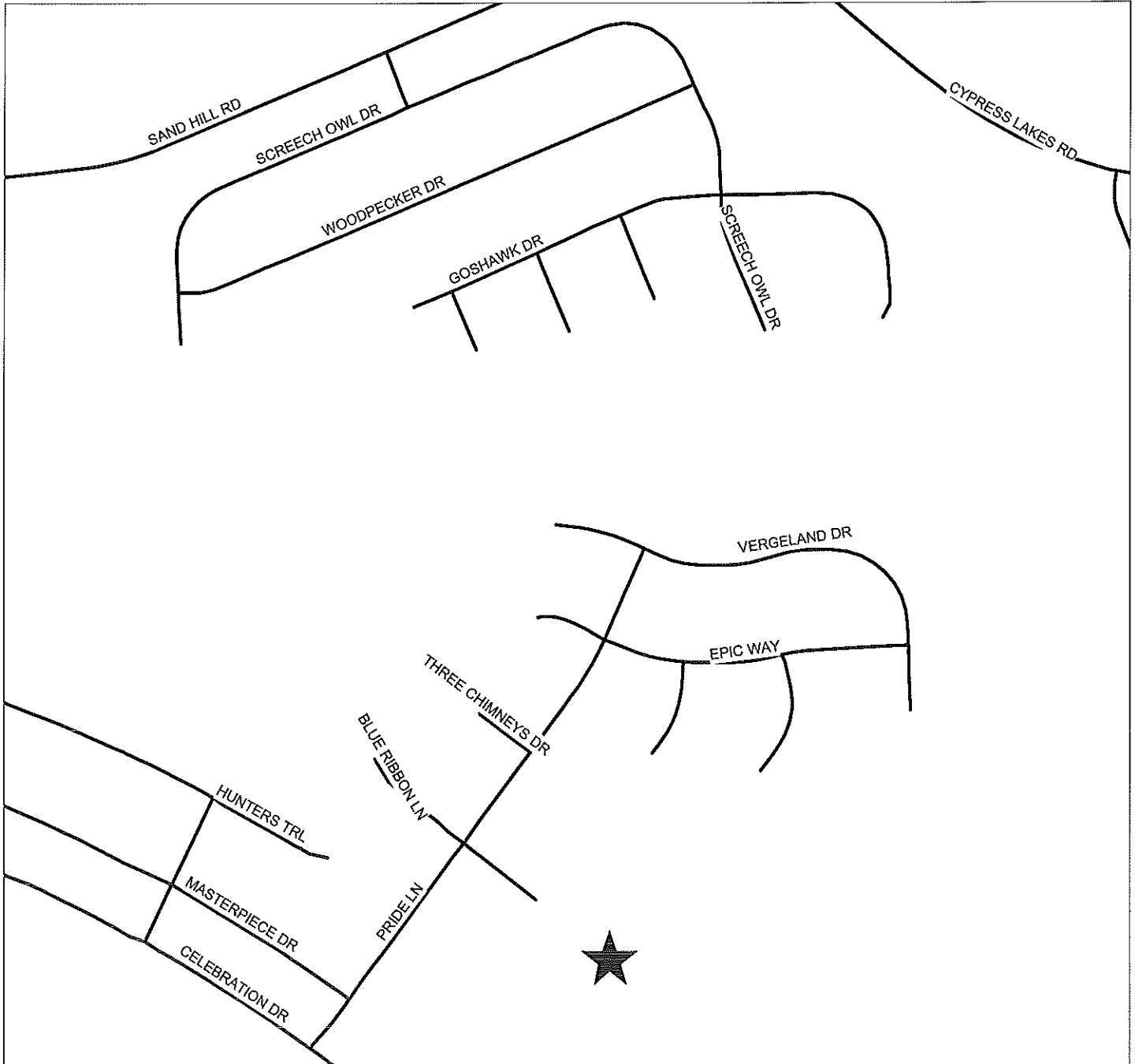

PIN(S): 0432-25-3989-  
red by GJB - CCJPB  
FEBRUARY 28, 2013

Map not to scale



**BIG JOHN'S FURNITURE STORE PROPERTY  
C3, SITE PLAN REVIEW  
CASE NO. 13-014**



PIN(S): 0466-16-2922-  
red by GJB - CCJPB  
FEBRUARY 1, 2013

Map not to scale



**KENNETH DAVIS PROPERTY  
ZERO LOT LINE SUBDIVISION REVIEW  
CASE NO. 13-013**



PIN(S): 0420-66-8148-  
red by GJB - CCJPB  
JANUARY 29, 2013

Map not to scale



**GARDEN GROVE PARK, LLC PROPERTY  
R6A/CD, SITE PLAN OFFICE ADDITIN REVIEW  
CASE NO. 13-015**

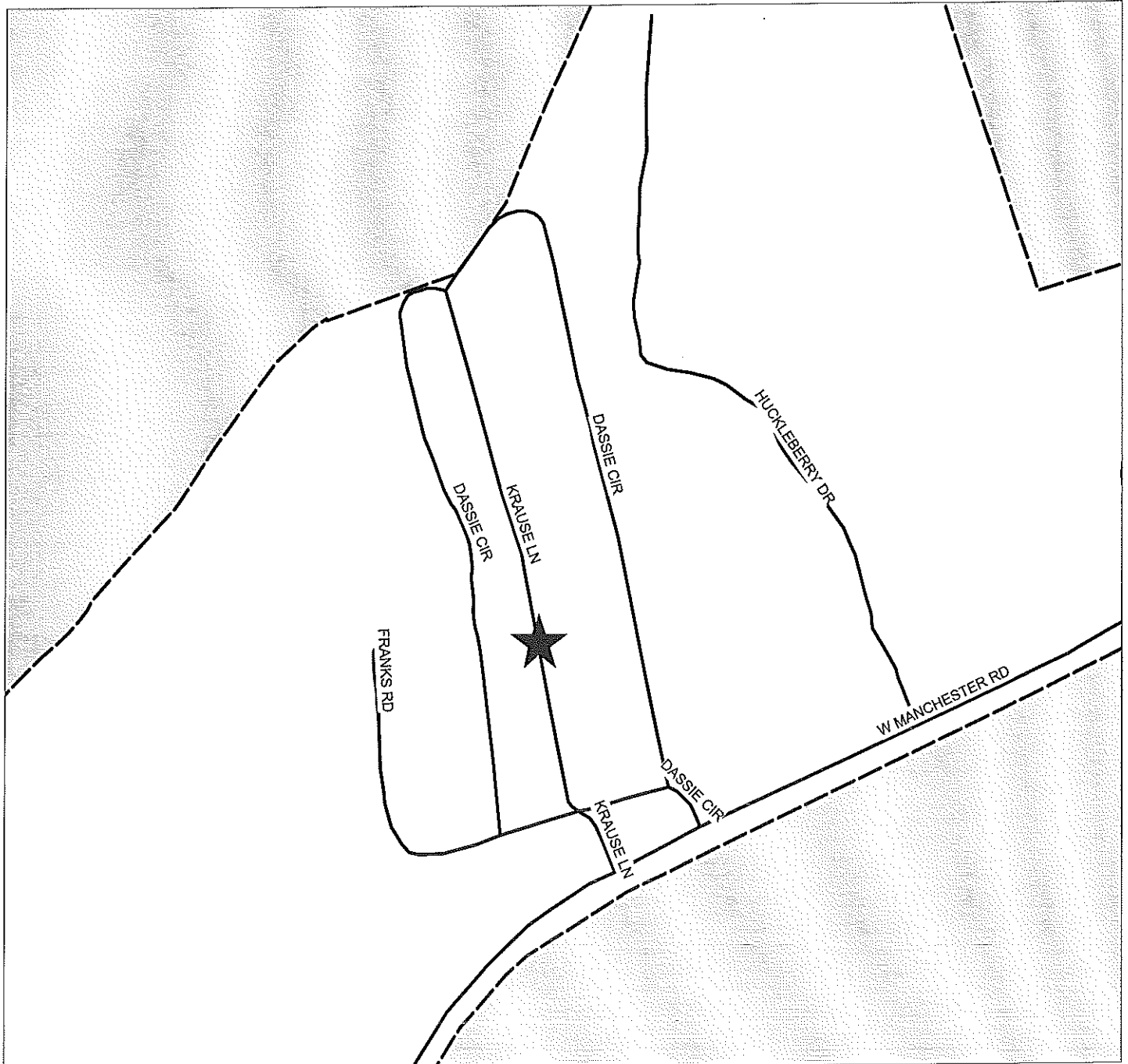

PIN(S): 9592-52-3523-  
red by GJB - CCJPB  
FEBRUARY 1, 2013

Map not to scale



**JAMES LAWRENCE TAYLOR PROPERTY  
SUBDIVISION REVIEW  
CASE NO. 13-012**



PIN(S): 0554-44-1286-  
red by GJB - CCJPB  
JANUARY 29, 2013

Map not to scale



**SAMUEL W. POPE PROPERTY  
ZERO LOT LINE SUBDIVISION REVIEW  
CASE NO. 13-016**

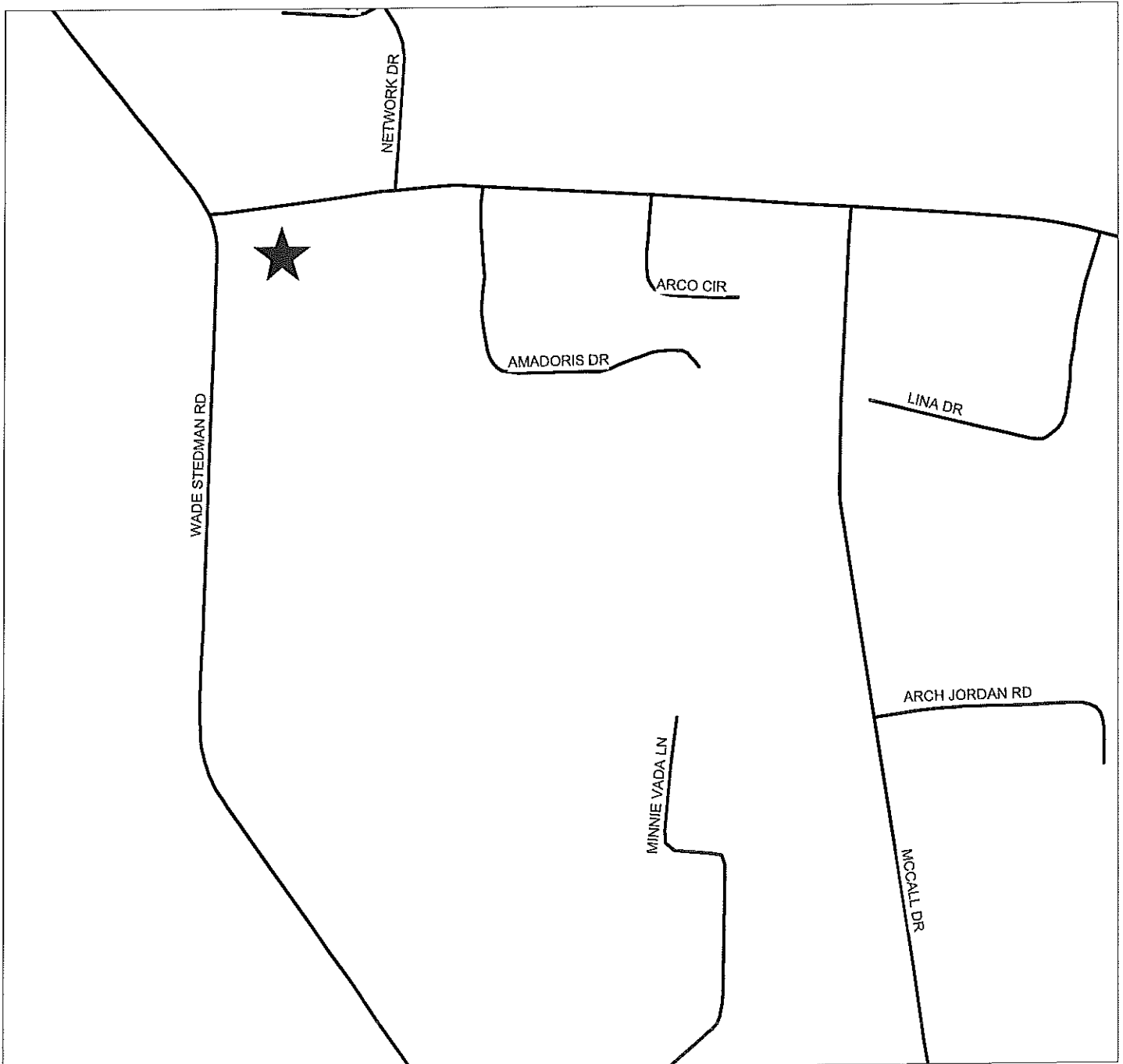

PIN(S): 0497-42-3073- & -0497-41-1974-  
red by GJB - CCJPB  
FEBRUARY 4, 2013

Map not to scale



**TRACE HOMES, INC. PROPERTY  
SUBDIVISION REVIEW  
CASE NO. 13-018**

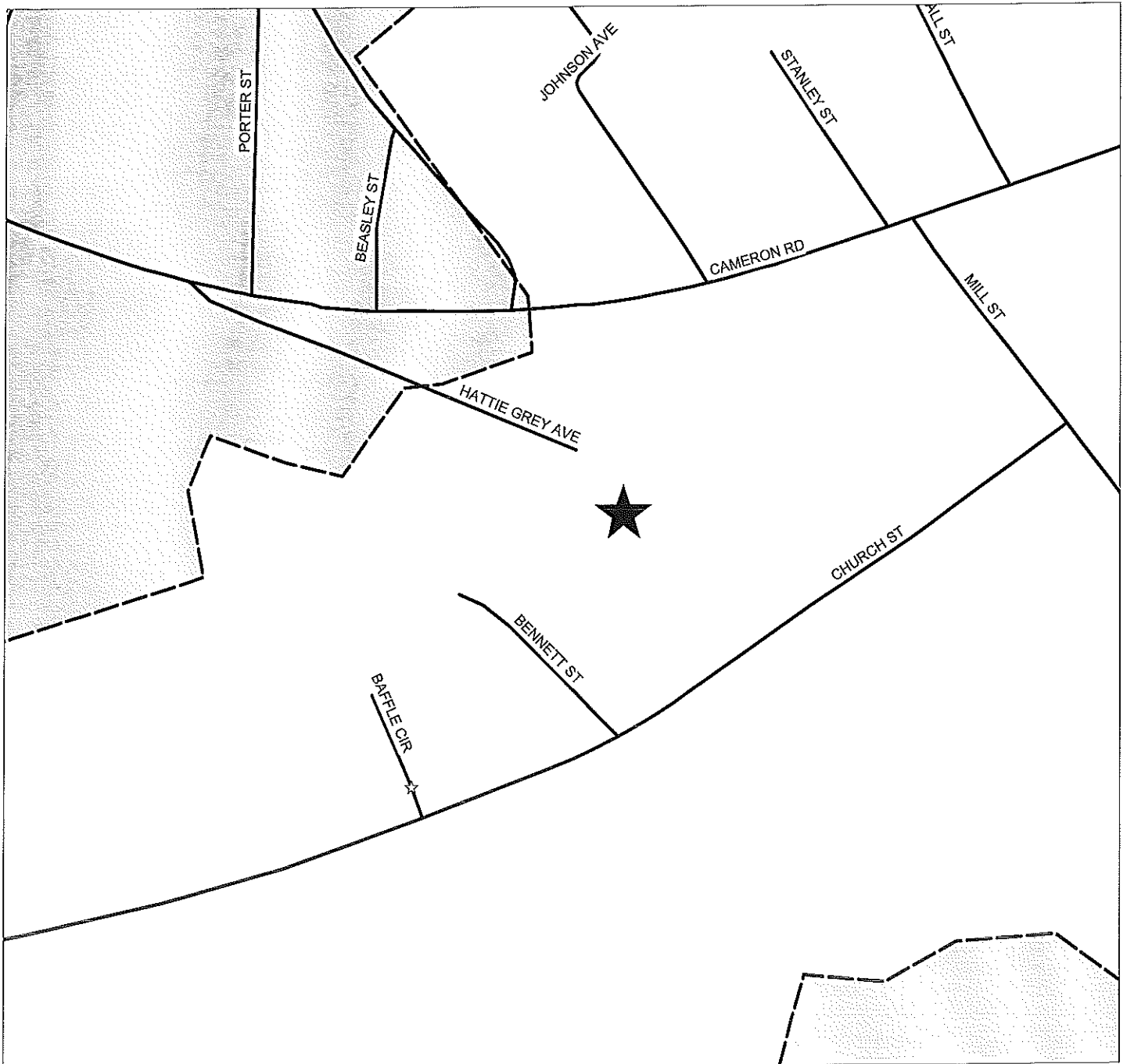

PIN(S): 0424-01-2893-  
red by GJB - CCJPB  
FEBRUARY 13, 2013

Map not to scale



**STONEY POINT SUBDIVISION PROPERTY  
SUBDIVISION REVIEW  
CASE NO. 12-091**

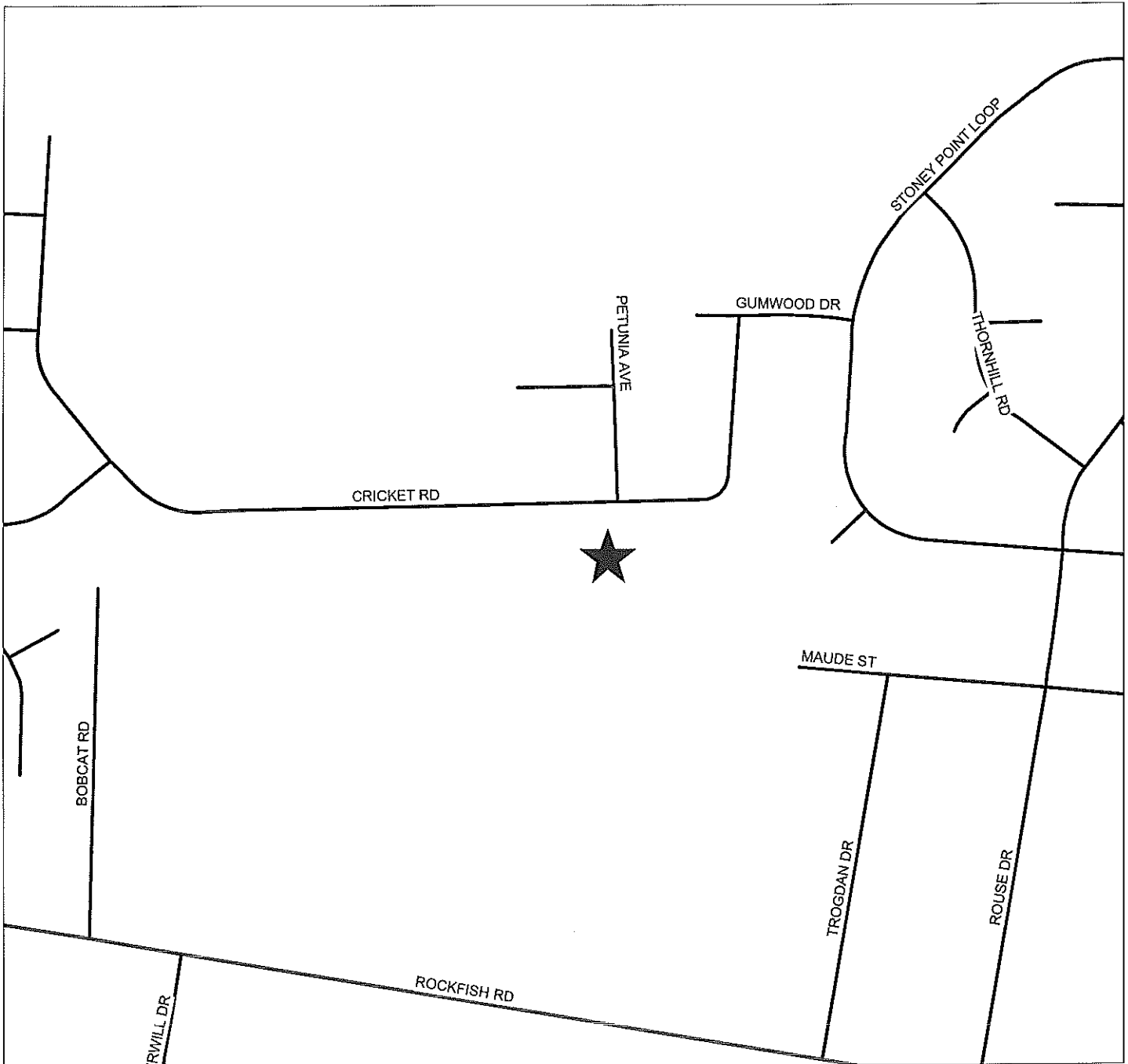

PIN(S): 0404-28-1412- & 0404-18- 5461-  
red by GJB - CCJPB  
JUNE 21, 2012

Map not to scale



**DAISY ENTERPRISES, INC. PROPERTY  
R6A & C(P) SITE PLAN REVIEW REVIEW  
CASE NO. 11 - 014**

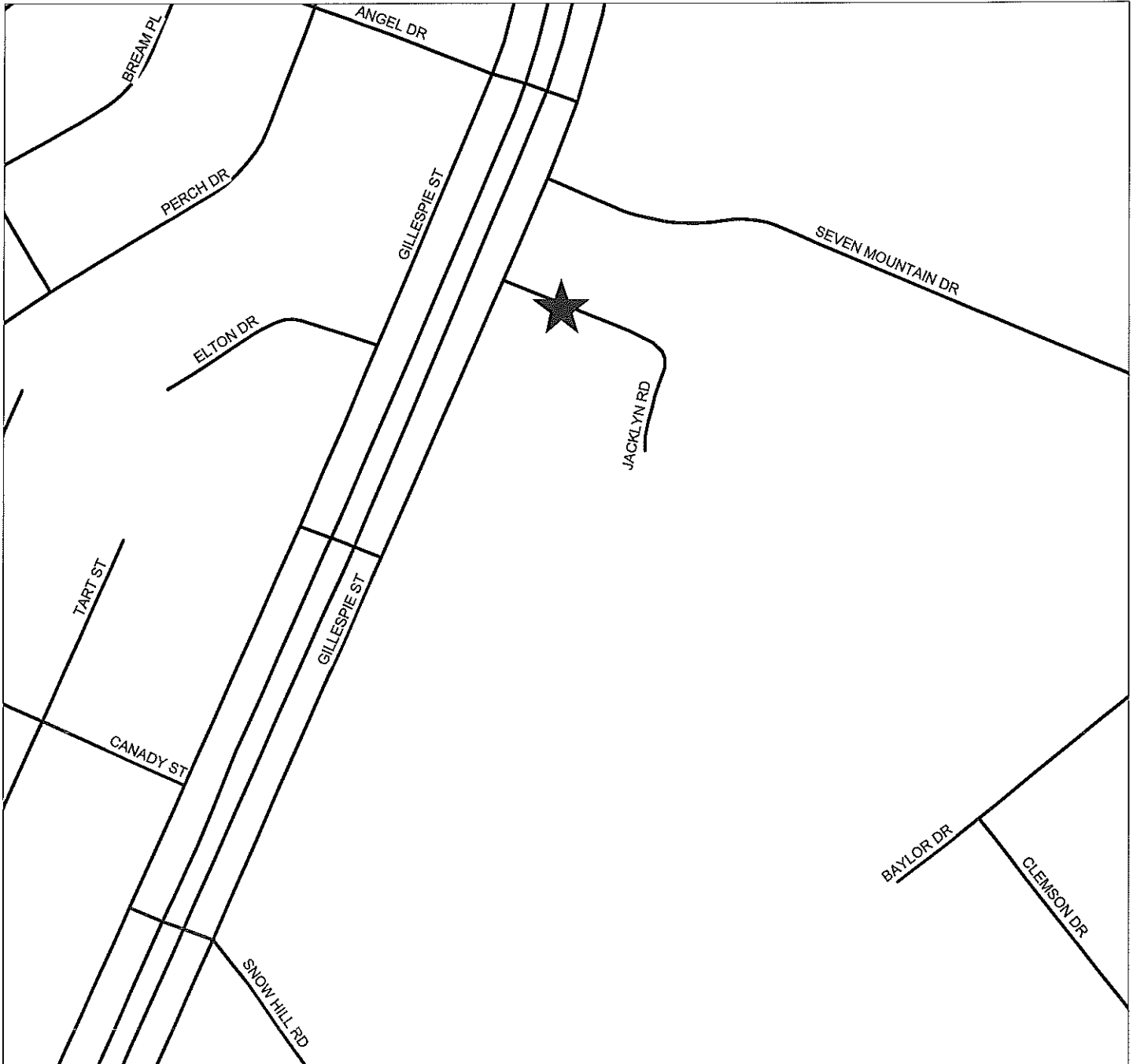

PIN(S): 0424-89-8457-  
Prepared by EMB - CCJPB  
FEBRUARY 8, 2011

Map not to scale



**BRIAN WILSON PROPERTY  
SUBDIVISION REVIEW  
CASE NO. 13-017**

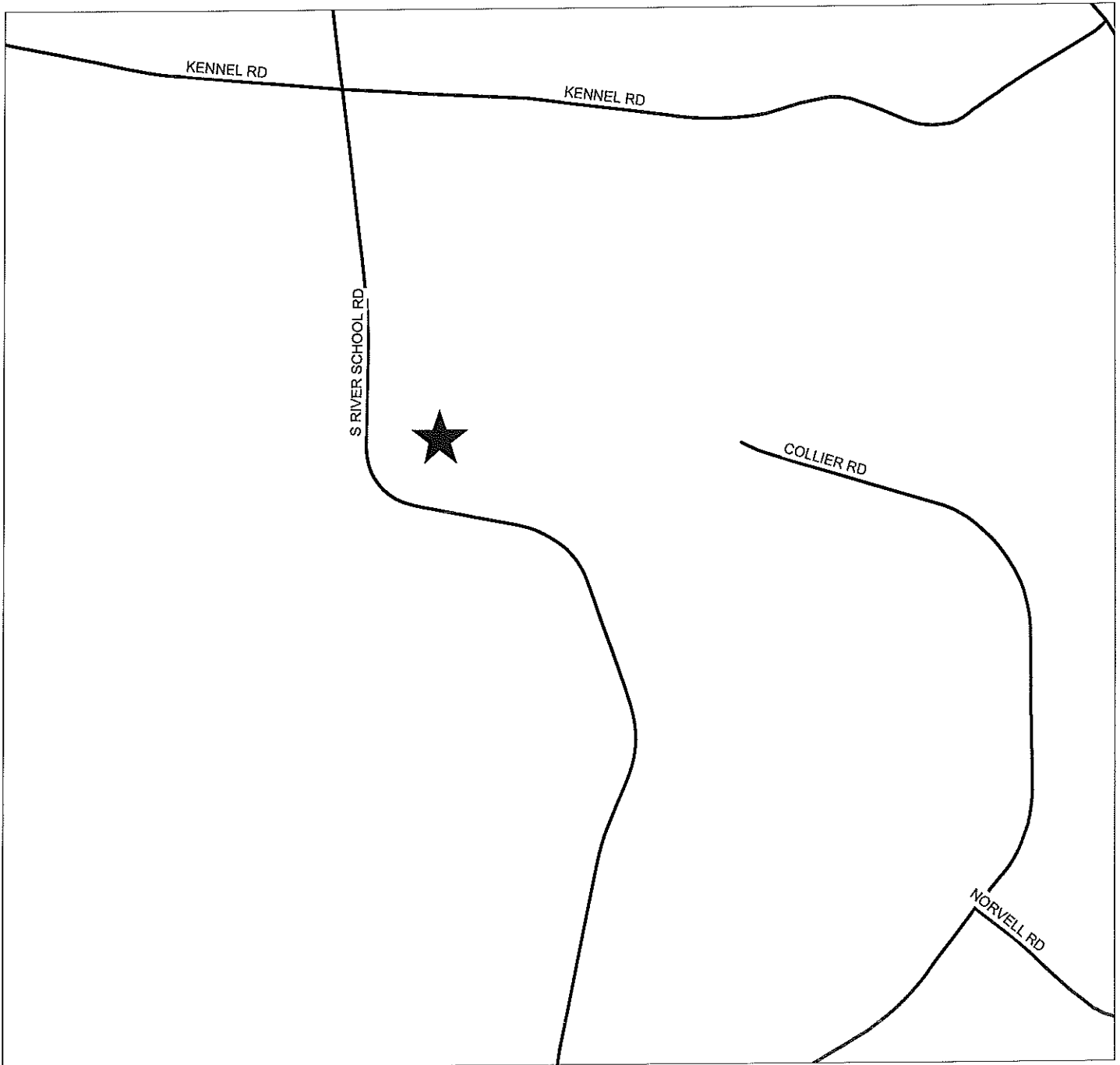

PIN(S): 0499-79-3772-  
red by GJB - CCJPB  
FEBRUARY 8, 2013

Map not to scale



**ISAAC YOUNG PROPERTY  
GROUP DEVELOPMENT REVIEW  
CASE NO. 12-100**



PIN(S): 0433-39-6751-  
red by GJB - CCJPB  
JULY 17, 2012

Map not to scale



**NEW HEAVEN CHURCH PROPERTY  
R6A, SITE PLAN REVIEW  
CASE NO. 12-044**



PIN(S): 0405-84-4379-  
red by GJB - CCJPB  
MARCH 20, 2012

Map not to scale



**STAR BRIGHT INVESTMENTS LLC**  
**C(P) SITE PLAN & GROUP DEVELOPMENT REVIEW**  
**CASE NO. 97-023**



PIN(S): 0501-59-6803-  
red by GJB - CCJPB  
FEBRUARY 4, 2013

Map not to scale



# SPRING LAKE AUTO CENTER AND SALVAGE M(P) SITE PLAN REVIEW

CASE NO. 02-258

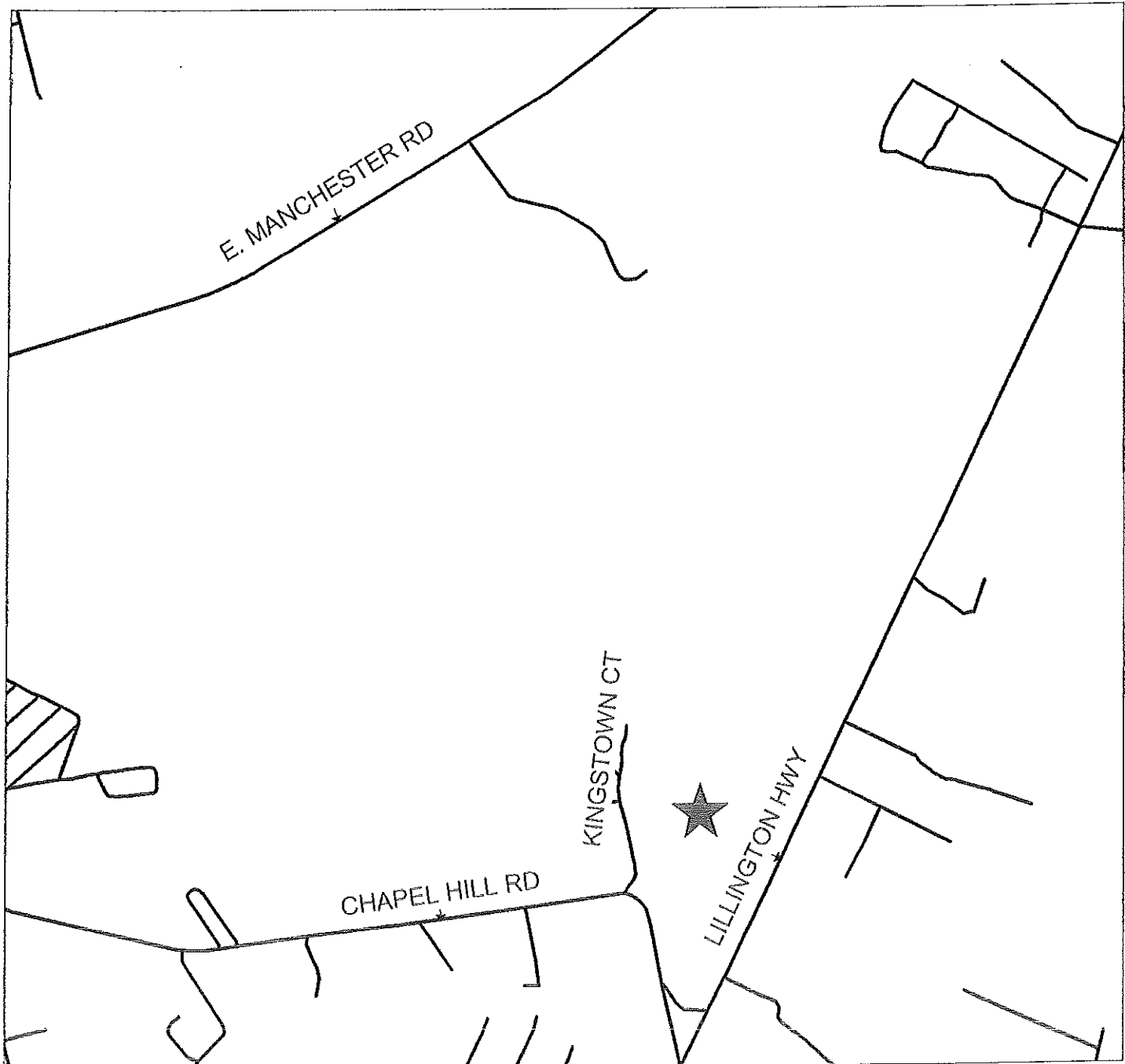

PIN: 0512.03-02-2914  
PREPARED BY K. J. M. - CCJPB  
NOVEMBER 18, 2002

Map not to scale



**STANLEY PROPERTY  
A1, SITE PLAN REVIEW  
CASE NO. 12-025**



PIN(S): 0471-25- 9217-  
red by GJB - CCJPB  
FEBRUARY 21, 2012

Map not to scale



**BOBBY & CLEO WASHINGTON PROPERTY  
SUBDIVISION REVIEW  
CASE NO. 13-020**



PIN(S): 0488-03-7323-  
red by GJB - CCJPB  
FEBRUARY 18, 2013

Map not to scale

