

Charles Morris,
Chair
Town of Linden

Diane Wheatley,
Vice-Chair
Cumberland County

Jami McLaughlin,
Town of Spring Lake
Harvey Cain, Jr.,
Town of Stedman

Donovan McLaurin
Wade, Falcon & Godwin



Thomas J. Lloyd,
Director

Cecil P. Combs,
Deputy Director

Vikki Andrews,
Carl Manning,
Lori Epler,
Cumberland County

Benny Pearce,
Town of Eastover

Patricia Hall,
Town of Hope Mills

COUNTY of CUMBERLAND

Planning & Inspections Department

May 26, 2017

MEMORANDUM

TO: Cumberland County Joint Planning Board
Cumberland County Board of Education
Embarq
Fayetteville Public Works Commission

FROM: Jeff Barnhill, Planner I
Land Use Codes Section

SUBJECT: Monthly Report for May 2017
Subdivision & Site Development Plans

The following list of projects is submitted for your information. Please find attached a copy of the respective vicinity maps indicated by the case number and project name.

1. CASE NO: 17-056
NAME OF DEVELOPMENT: Jeremy Hunt Property
TYPE OF REVIEW: Site Plan/Recombination Review
LOCATION: North side of Doc Bennet Road, north of I-95
ZONING: M(P) Heavy Industrial & AOD Airport Overlay Districts
NUMBER OF UNITS: 1
TOTAL ACREAGE: 54.58 +/-
JURISDICTION: Cumberland County
STAFF APPROVAL DATE: May 2, 2017
OWNER/DEVELOPER: Jeremy Hunt
2. CASE NO: 17-051
NAME OF DEVELOPMENT: Hardee's Hope Mills Market Place
TYPE OF REVIEW: C2(P) Site Plan Review
LOCATION: 4260 Legion Road
ZONING: C2(P) Planned Commercial District
NUMBER OF UNITS: 1
TOTAL ACREAGE: .84 +/-
JURISDICTION: Hope Mills
STAFF APPROVAL DATE: April 20, 2017
HOPE MILLS COMMISSIONER'S APPROVAL DATE: May 1, 2017
OWNER/DEVELOPER: Reggie Barnacascel, Jr.

3. CASE NO: 07-184
NAME OF DEVELOPMENT: The Church of the Apostles
TYPE OF REVIEW: Site Plan Review
LOCATION: East side of SR 2252 (Chicken Foot Road)
ZONING: R40 Residential District
NUMBER OF UNITS: 1
TOTAL ACREAGE: 13.7 +/-
JURISDICTION: Cumberland County
STAFF APPROVAL DATE: May 1, 2017
OWNER/DEVELOPER: The Church of the Apostles
4. CASE NO: 17-060
NAME OF DEVELOPMENT: Hylton Leftwich Property
TYPE OF REVIEW: Group Development Review
LOCATION: 3618 & 3614 Coleman Road
ZONING: A1 Agricultural District
NUMBER OF UNITS: 2
TOTAL ACREAGE: 2.00 +/-
JURISDICTION: Cumberland County
STAFF APPROVAL DATE: May 4, 2017
OWNER/DEVELOPER: Hylton Leftwich
5. CASE NO: 17-058
NAME OF DEVELOPMENT: Mitchell Gilmore Property
TYPE OF REVIEW: Zero Lot Line Subdivision Review
LOCATION: 4938 S. Main Street
ZONING: R6A Planned Residential District
NUMBER OF LOTS: 3
TOTAL ACREAGE: 3.30 +/-
JURISDICTION: Cumberland County
STAFF APPROVAL DATE: May 5, 2017
OWNER/DEVELOPER: Mitchell Gilmore
6. CASE NO: 17-061
NAME OF DEVELOPMENT: Rockfish Run/Horace Dew Property
TYPE OF REVIEW: Review
LOCATION: 4957 Gray's Creek Church Road
ZONING: R40 Planned Residential District
NUMBER OF LOTS: 2
TOTAL ACREAGE: 1.70 +/-
JURISDICTION: Cumberland County
STAFF APPROVAL DATE: May 8, 2017
OWNER/DEVELOPER: Rockfish Run
7. CASE NO: 17-053
NAME OF DEVELOPMENT: Bethel AME Zion Church
TYPE OF REVIEW: Subdivision/Site Plan Review
LOCATION: 255 Vass Road
ZONING: R10 Planned Residential District
NUMBER OF LOTS: 2
TOTAL ACREAGE: 1.63 +/-
JURISDICTION: Spring Lake

STAFF APPROVAL DATE: April 20, 2017
SPRING LAKE ALDERMAN APPROVAL DATE: May 8, 2017
OWNER/DEVELOPER: Jasper Musgrave

8. CASE NO: 17-064
NAME OF DEVELOPMENT: John Canady Heirs Property
TYPE OF REVIEW: Zero Lot Line Subdivision Review
LOCATION: 7037 Roslin Farm Road
ZONING: A1 Agricultural District
NUMBER OF LOTS: 4
TOTAL ACREAGE: 15.73 +/-
JURISDICTION: Cumberland County
STAFF APPROVAL DATE: May 8, 2017
OWNER/DEVELOPER: John Canady Heirs
9. CASE NO: 17-065
NAME OF DEVELOPMENT: Jeffrey Bryant Property
TYPE OF REVIEW: Group Development Review
LOCATION: 2638 Pinecrest Drive
ZONING: RR Rural Residential District
NUMBER OF UNITS: 2
TOTAL ACREAGE: .70 +/-
JURISDICTION: Cumberland County
STAFF APPROVAL DATE: May 9, 2017
OWNER/DEVELOPER: Jeffrey Bryant
10. CASE NO: 17-062
NAME OF DEVELOPMENT: Emily Pittman Property
TYPE OF REVIEW: Subdivision Review
LOCATION: 4701 NC HWY 42
ZONING: A1 Agricultural District
NUMBER OF LOTS: 3
TOTAL ACREAGE: 38.30 +/-
JURISDICTION: Cumberland County
STAFF APPROVAL DATE: May 9, 2017
OWNER/DEVELOPER: Emily Pittman
11. CASE NO: 17-047
NAME OF DEVELOPMENT: Dorothy Long Property
TYPE OF REVIEW: Subdivision/Group Development Review
LOCATION: South Side of SR 1815 (Wade-Stedman Road), east side of SR 1827 (Covington Lane)
ZONING: A1 Agricultural & RR Rural Residential Districts
NUMBER OF LOTS: 2
TOTAL ACREAGE: 10.36 +/-
JURISDICTION: Wade
STAFF APPROVAL DATE: April 13, 2017
WADE COMMISSIONER'S APPROVAL DATE: May 9, 2017
OWNER/DEVELOPER: Dorothy Long
12. CASE NO: 17-059
NAME OF DEVELOPMENT: Freedom Baptist Church

- TYPE OF REVIEW: Site Plan Review
LOCATION: 2115 Middle Road
ZONING: A1 Agricultural Districts
NUMBER OF UNITS: 1
TOTAL ACREAGE: 9.50 +/-
JURISDICTION: Eastover
STAFF APPROVAL DATE: May 1, 2017
EASTOVER TOWN COUNCIL APPROVAL DATE: May 9, 2017
OWNER/DEVELOPER: Freedom Baptist Church
13. CASE NO: 07-030
NAME OF DEVELOPMENT: King Travelers – Retail Shops
TYPE OF REVIEW: Site Plan Review
LOCATION: 3209, 3211, 3213 Cedar Creek Road
ZONING: C3 & C(P) Planned Commercial Districts
NUMBER OF UNITS: 1
TOTAL ACREAGE: 1.33 +/-
JURISDICTION: Cumberland County
STAFF APPROVAL DATE: May 11, 2017
OWNER/DEVELOPER: Richard King
14. CASE NO: 07-057
NAME OF DEVELOPMENT: Centurylink
TYPE OF REVIEW: Site Plan Review
LOCATION: 5462 River Road
ZONING: R10 Residential District
NUMBER OF UNITS: 1
TOTAL ACREAGE: 4.54 +/-
JURISDICTION: Hope Mills
STAFF APPROVAL DATE: May 03, 2017
HOPE MILLS COMMISSIONER'S APPROVAL DATE: May 15, 2017
OWNER/DEVELOPER: Centurylink
15. CASE NO: 16-111
NAME OF DEVELOPMENT: Roslin Farms West section 4
TYPE OF REVIEW: Zero Lot Line Subdivision Review
LOCATION: 6742 Roslin Farm Road
ZONING: A1 Agricultural, R30 Planned Residential Districts
NUMBER OF LOTS: 59
TOTAL ACREAGE: 64.29 +/-
JURISDICTION: Cumberland County
STAFF APPROVAL DATE: October 20, 2016
REVISED STAFF APPROVAL DATE: May 16, 2017
OWNER/DEVELOPER: Charles Gardner
16. CASE NO: 17-052
NAME OF DEVELOPMENT: Joann Honeycutt Heirs Properties
TYPE OF REVIEW: Subdivision Review
LOCATION: 304 & 257 Fred Hall Road
ZONING: A1 Agricultural District
NUMBER OF LOTS: 59
TOTAL ACREAGE: 52.73 +/-

- JURISDICTION: Cumberland County
STAFF APPROVAL DATE: April 21, 2017
REVISED STAFF APPROVAL DATE: May 15, 2017
OWNER/DEVELOPER: Terry Faircloth
17. CASE NO: 17-075
NAME OF DEVELOPMENT: James & Isabella Ostendorf Property
TYPE OF REVIEW: Subdivision Review
LOCATION: 329 Ostendorf Lane
ZONING: PND Planned Neighborhood District
NUMBER OF LOTS: 4
TOTAL ACREAGE: 4.48 +/-
JURISDICTION: Cumberland County
STAFF APPROVAL DATE: April 25, 2017
OWNER/DEVELOPER: James Ostendorf
18. CASE NO: 17-070
NAME OF DEVELOPMENT: Stephen Autry Property
TYPE OF REVIEW: Subdivision Review
LOCATION: South side of SR 1122 (Woodington Road), east of Parkton Road
ZONING: RR Residential District
NUMBER OF LOTS: 2
TOTAL ACREAGE: 45.64 +/-
JURISDICTION: Cumberland County
STAFF APPROVAL DATE: May 18, 2017
OWNER/DEVELOPER: Stephen Autry
19. CASE NO: 17-071
NAME OF DEVELOPMENT: Kenneth Lamm Property
TYPE OF REVIEW: Subdivision Review
LOCATION: 6116 Percy Strickland Road
ZONING: A1 Agricultural District
NUMBER OF LOTS: 2
TOTAL ACREAGE: 34.02 +/-
JURISDICTION: Cumberland County
STAFF APPROVAL DATE: May 18, 2017
OWNER/DEVELOPER: Kenneth Lamm
20. CASE NO: 01-239
NAME OF DEVELOPMENT: Waste Management Vehicle Maint.
TYPE OF REVIEW: Site Plan Review
LOCATION: 691 Tom Starling Road
ZONING: M(P) Heavy Industrial District
NUMBER OF UNITS: 1
TOTAL ACREAGE: 20.75 +/-
JURISDICTION: Cumberland County
STAFF APPROVAL DATE: May 18, 2017
OWNER/DEVELOPER: Waste Management of the Carolinas
21. CASE NO: 17-066
NAME OF DEVELOPMENT: Primaerica Financial Services
TYPE OF REVIEW: Site Plan Review

- LOCATION: 110 N. Main Street
ZONING: CB Central Business, MSOD Main Street Overlay Districts
NUMBER OF UNITS: 1
TOTAL ACREAGE: .19 +/-
JURISDICTION: Spring Lake
STAFF APPROVAL DATE: May 05, 2017
SPRING LAKE APPROVAL DATE: May 22, 2017
OWNER/DEVELOPER: Nathan Bell
22. CASE NO: 17-067
NAME OF DEVELOPMENT: FTCC Law Enforcement Training Center
TYPE OF REVIEW: Site Plan Review
LOCATION: 108 McKenzie Road
ZONING: C(P) Planned Commercial District
NUMBER OF UNITS: 1
TOTAL ACREAGE: 1.60 +/-
JURISDICTION: Spring Lake
STAFF APPROVAL DATE: May 12, 2017
SPRING LAKE APPROVAL DATE: May 22, 2017
OWNER/DEVELOPER: Fayetteville Tech. Comm. College
23. CASE NO: 17-072
NAME OF DEVELOPMENT: Edgewoods Farm West
TYPE OF REVIEW: Zero Lot Line Subdivision Review
LOCATION: South side of SR 2233 (School Road), west of SR 2251
(Yarborough Road)
ZONING: R40 Residential, & A1 Agricultural Districts
NUMBER OF LOTS: 27
TOTAL ACREAGE: 28.7 +/-
JURISDICTION: Cumberland County
STAFF APPROVAL DATE: May 23, 2017
OWNER/DEVELOPER: Jeff Devore
24. CASE NO: 17-063
NAME OF DEVELOPMENT: J. Floyd Lee Property
TYPE OF REVIEW: Subdivision Review
LOCATION: West side of SR 1815 (Wade-Stedman Road)
ZONING: A1 Agricultural District
NUMBER OF LOTS: 9
TOTAL ACREAGE: 34.3 +/-
JURISDICTION: Cumberland County
STAFF APPROVAL DATE: May 31, 2017
OWNER/DEVELOPER: J. Floyd Lee

**JEREMY & MELISSA HUNT PROPERTY
RECOMBINATION & SITE PLAN REVIEW
CASE NO. 17-056**

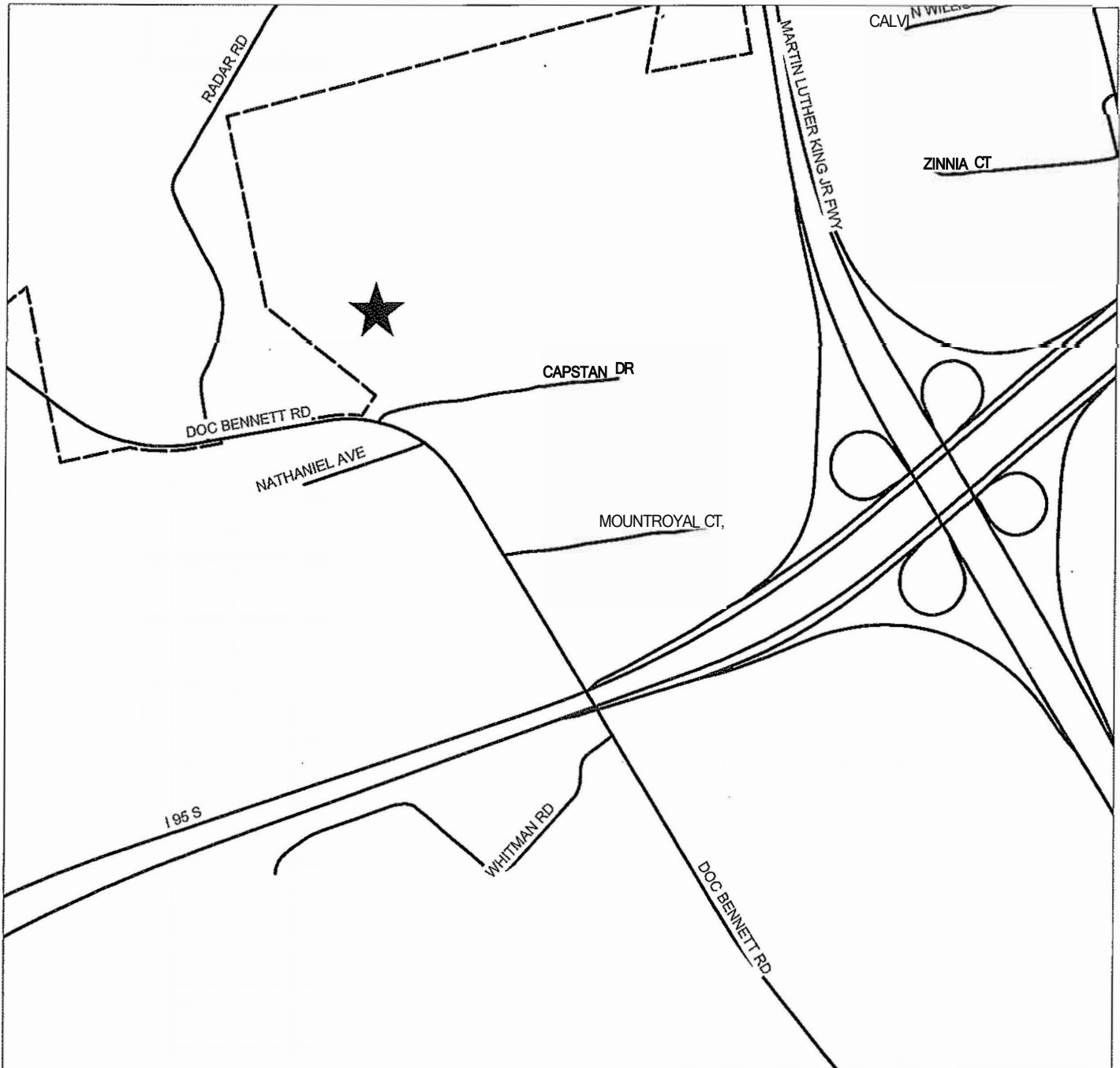

PIN(S): -0434-87-8075-, -97-5318-, -98-0232-
Created by GJB - EMB
APRIL 20, 2017

Map not to scale



**HARDEE'S - HOPE MILLS MARKET PLACE
C2(P) SITE PLAN REVIEW
CASE NO. 17-051**

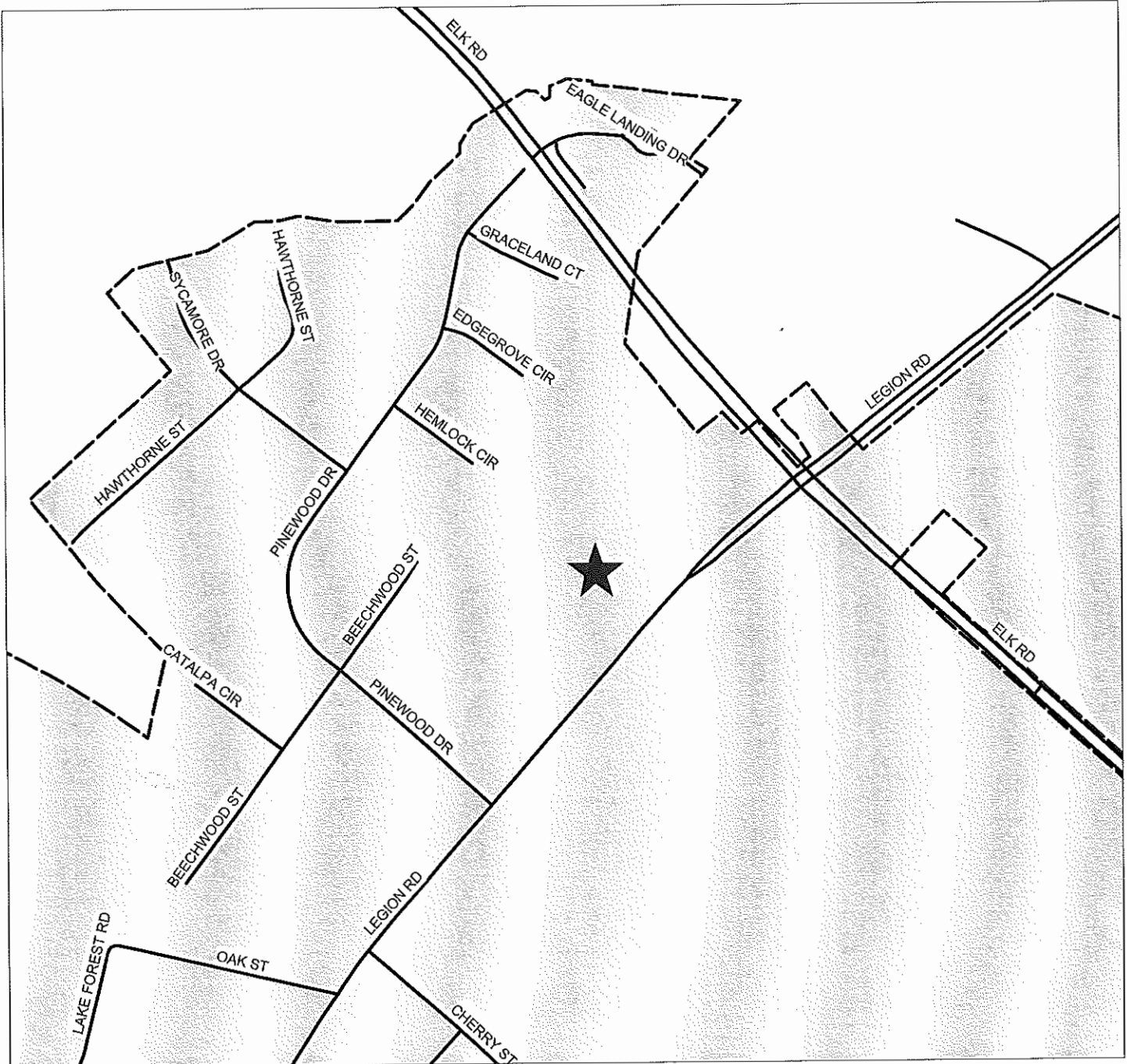

PIN(S): -0424-08-0506-
Created by GJB - EMB
APRIL 18, 2017

Map not to scale



**THE CHURCH OF THE APOSTLES PROPERTY
R40 SITE PLAN REVIEW
CASE NO. 07-184**



PINS: 0422-90-5829-
Prepared by EMB- CCJPB
October 29, 2007

Map not to scale



**HYLTON LEFTWICH PROPERTY
GROUP DEVELOPMENT REVIEW
CASE NO. 17-060**



PIN(S): -0560-22-2416-
Created by GJB - EMB
MAY 4, 2017

Map not to scale



**MITCHELL GILMORE PROPERTY
ZERO LOT LINE SUBDIVISION REVIEW
CASE NO. 17-058**



PIN(S): -0413-95-6586-
Created by GJB - EMB
APRIL 25, 2017

Map not to scale



**BETHEL AME ZION CHURCH
ZERO LOT LINE SUBDIVISION REVIEW
CASE NO. 17-053**

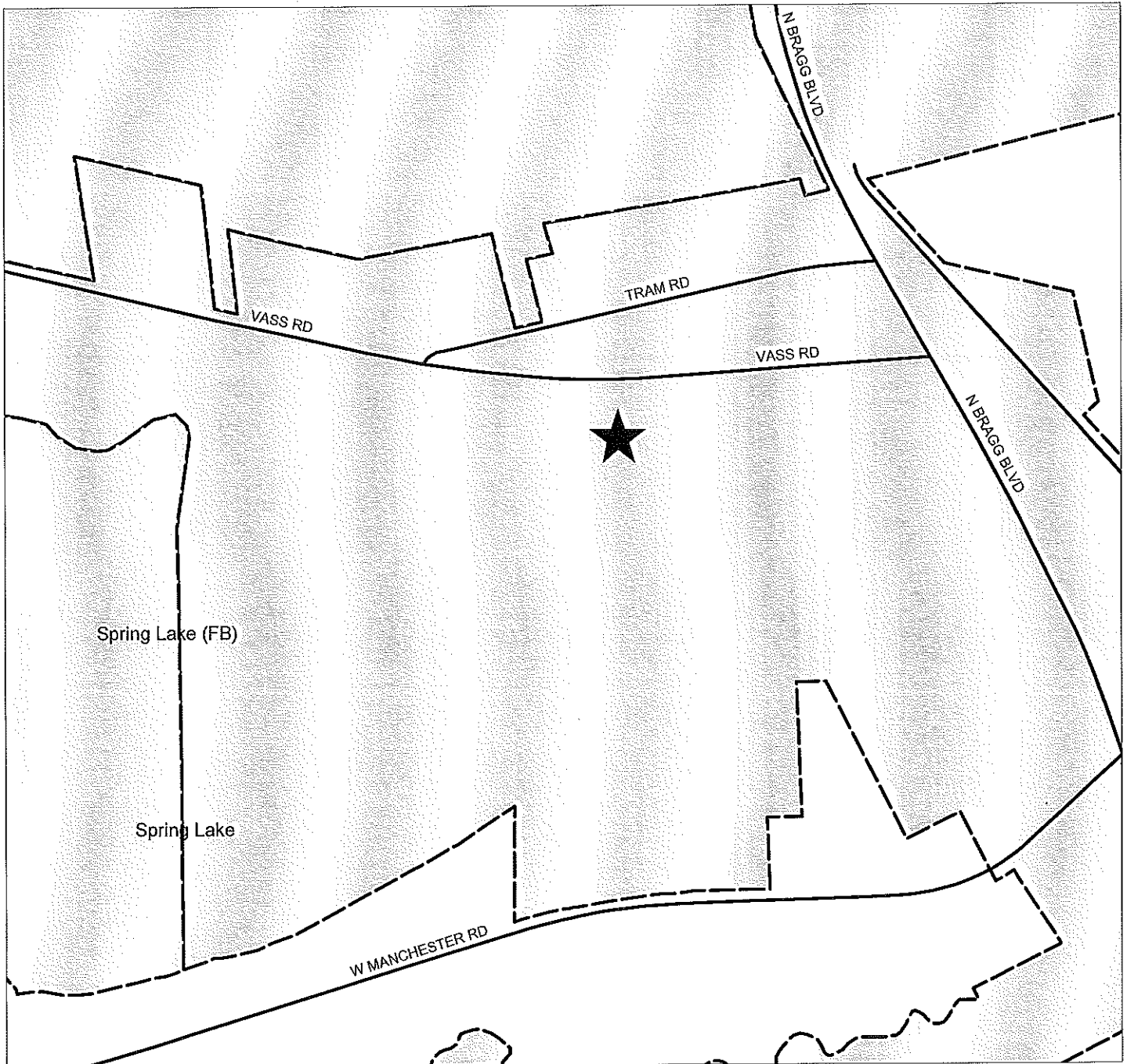

PIN(S): -0502-25-3927-
Created by GJB - EMB
APRIL 17, 2017

Map not to scale



**ROCKFISH RUN/HORACE DEW PROPERTY
ZERO LOT LINE SUBDIVISION REVIEW
CASE NO. 17-061**

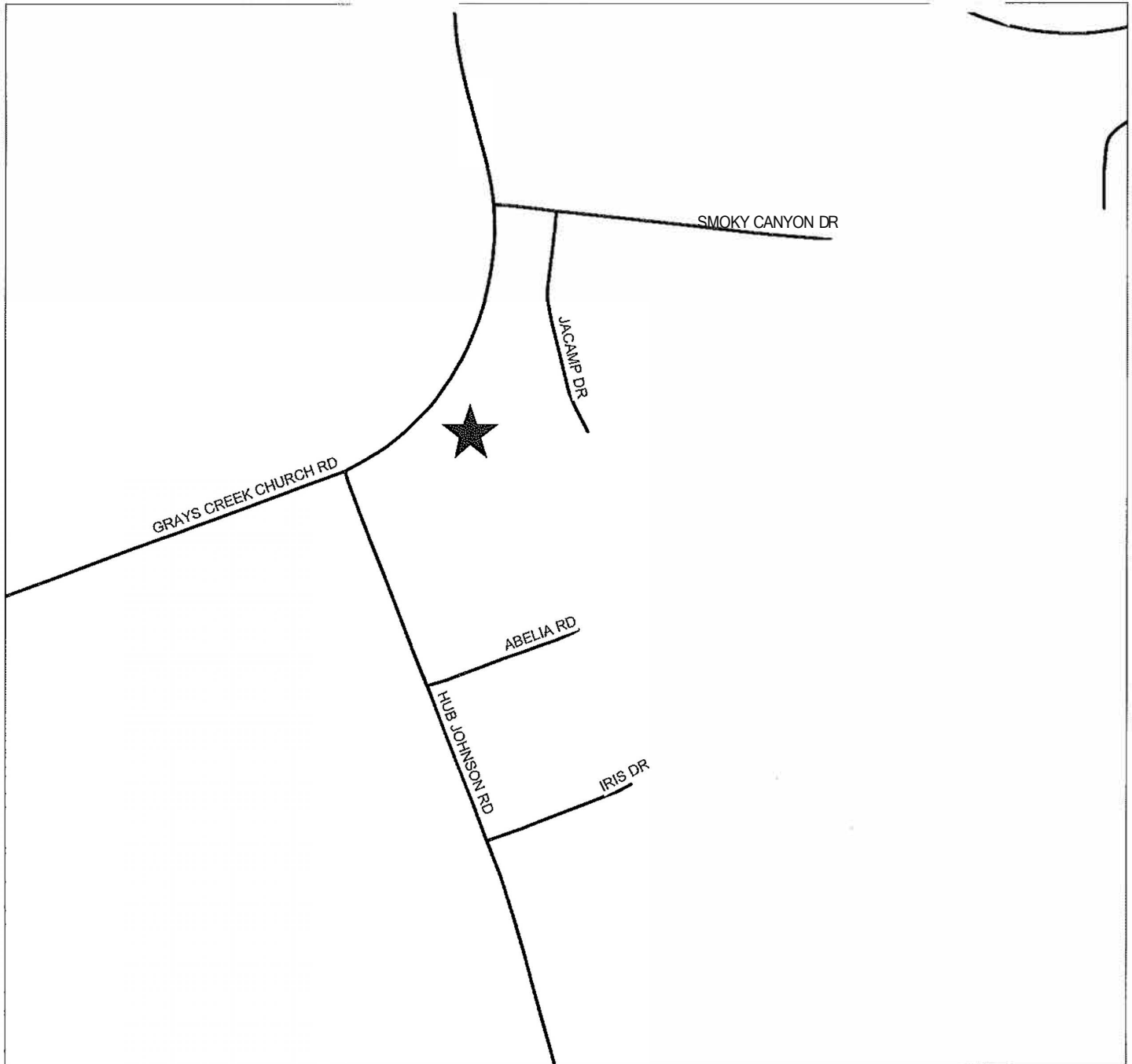

PIN(S): -0441-79-2674-, 0441-79-4924-, 0441-79-5811-
Created by GJB - EMB
MAY 8, 2017

Map not to scale



**JOHN CANADY HEIRS PROPERTY
ZERO LOT LINE SUBDIVISION REVIEW
CASE NO. 17-064**

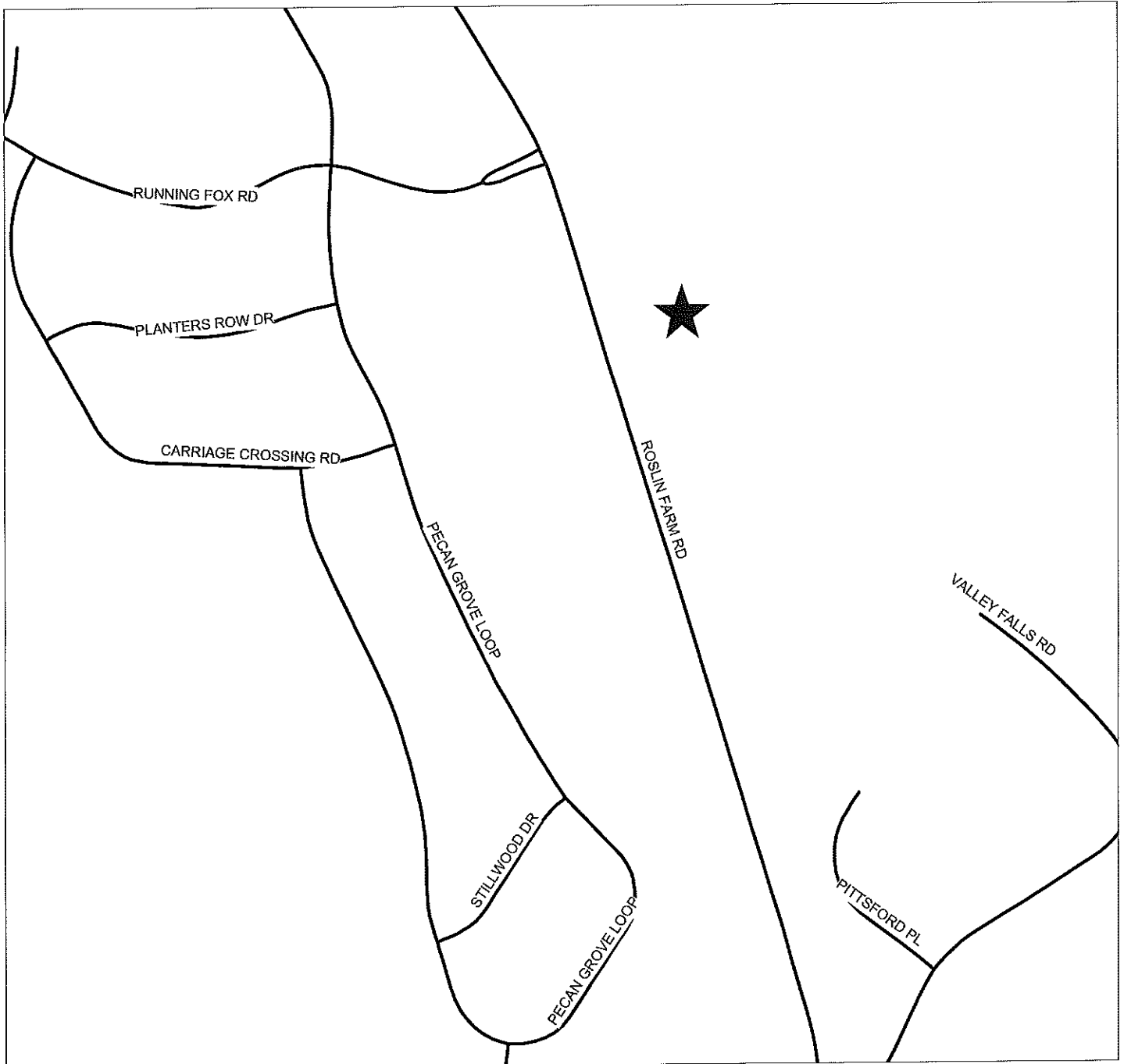

PIN(S): -0422-00-4752-
Created by GJB - EMB
MAY 4, 2017

Map not to scale



**JEFFREY BRYANT PROPERTY
GROUP DEVELOPMENT REVIEW
CASE NO. 17-065**

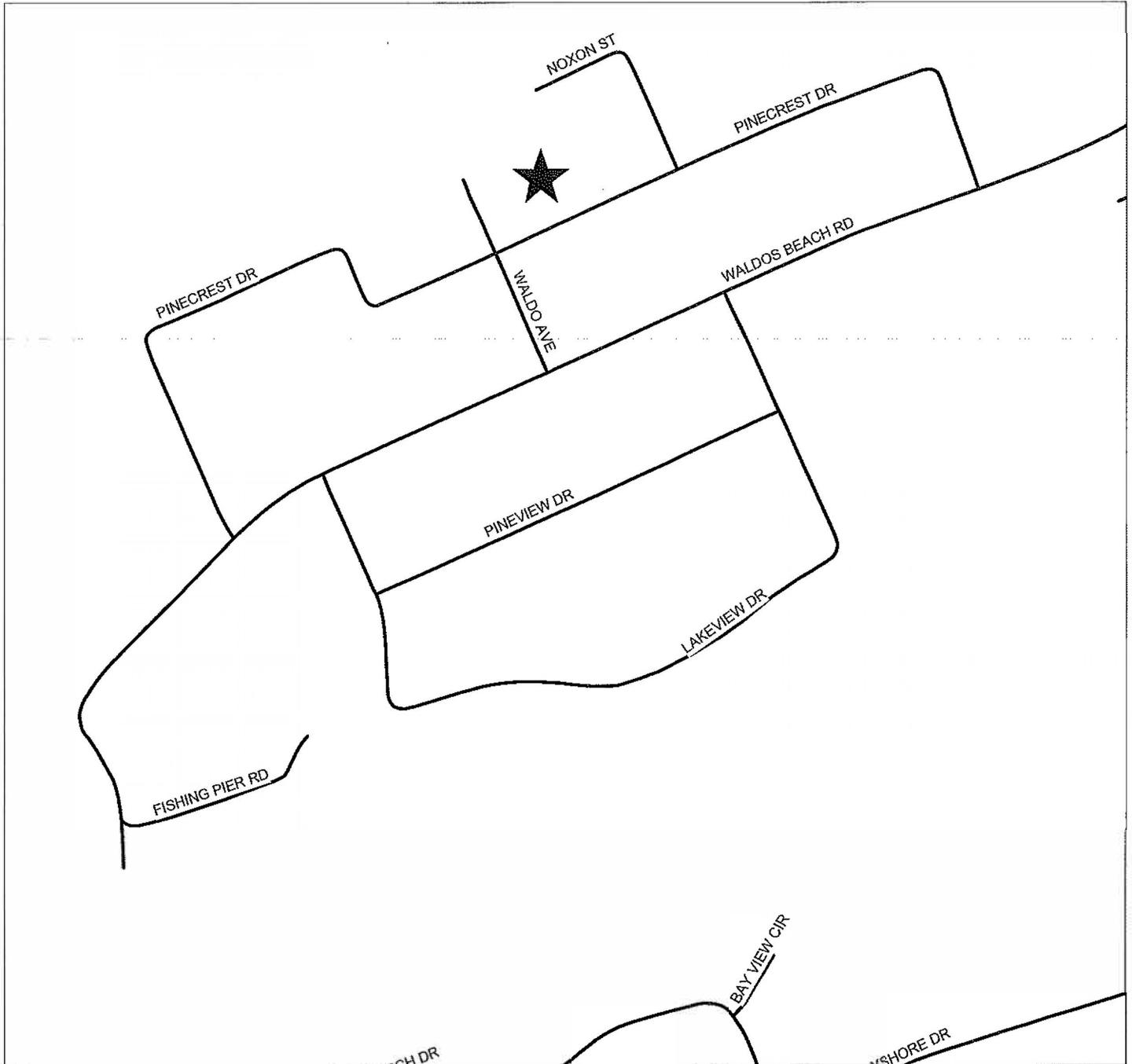

PIN(S): -9494-51-2437-
Created by GJB - EMB
MAY 4, 2017

Map not to scale



**EMILY PITTMAN PROPERTY
SUBDIVISION REVIEW
CASE NO. 17-062**



PIN(S): -1430-73-5810-
Created by GJB - EMB
MAY 9, 2017

Map not to scale



**DOROTHY ANN LONG PROPERTY
SUBDIVISION REVIEW
CASE NO. 17-047**

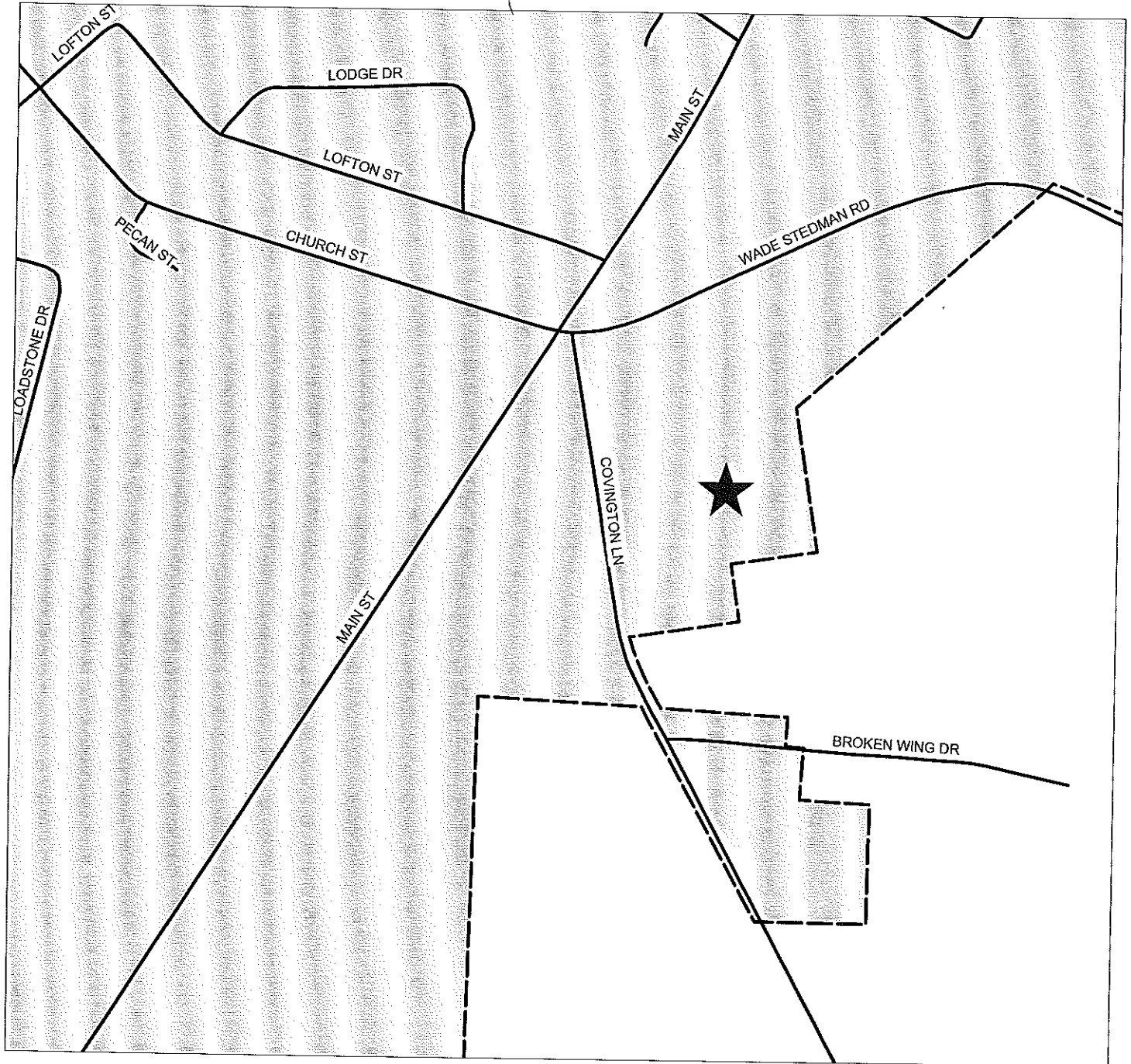

PIN(S): -0581-13-4102-
Created by GJB - EMB
APRIL 10, 2017

Map not to scale



**FREEDOM BAPTIST CHURCH PROPERTY
A1 SITE PLAN REVIEW
CASE NO. 17-059**

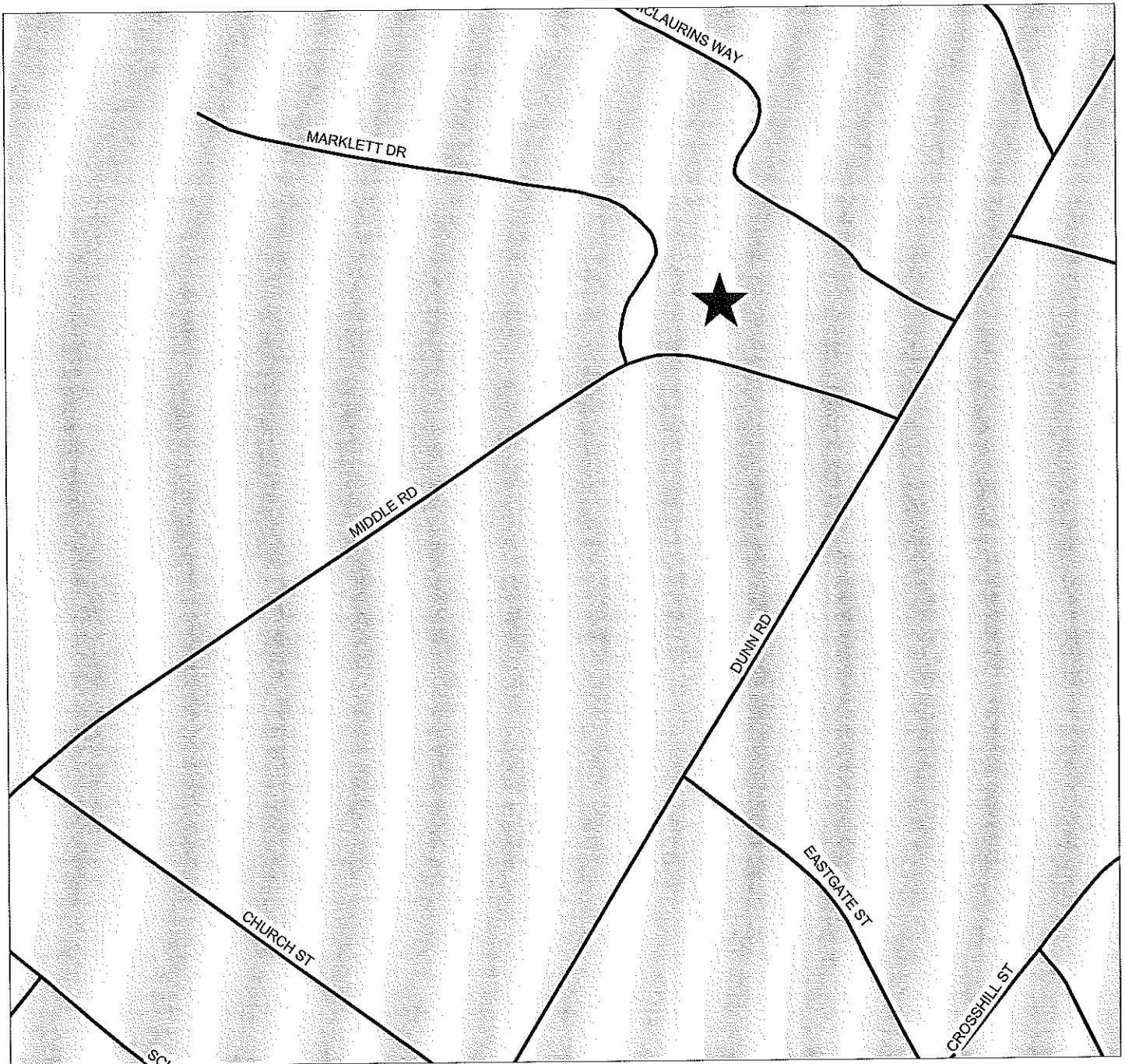

PIN(S): -0468-09-7530-
Created by GJB - EMB
APRIL 25, 2017

Map not to scale



**BLACK & DECKER PROPERTY
M(P) SITE PLAN REVIEW
CASE NO. 17-030**



PIN(S): -0425-85-0641-
Created by GJB - EMB
March 7, 2017

Map not to scale



**CENTURYLINK
R10 SITE PLAN REVIEW
CASE NO. 17-057**

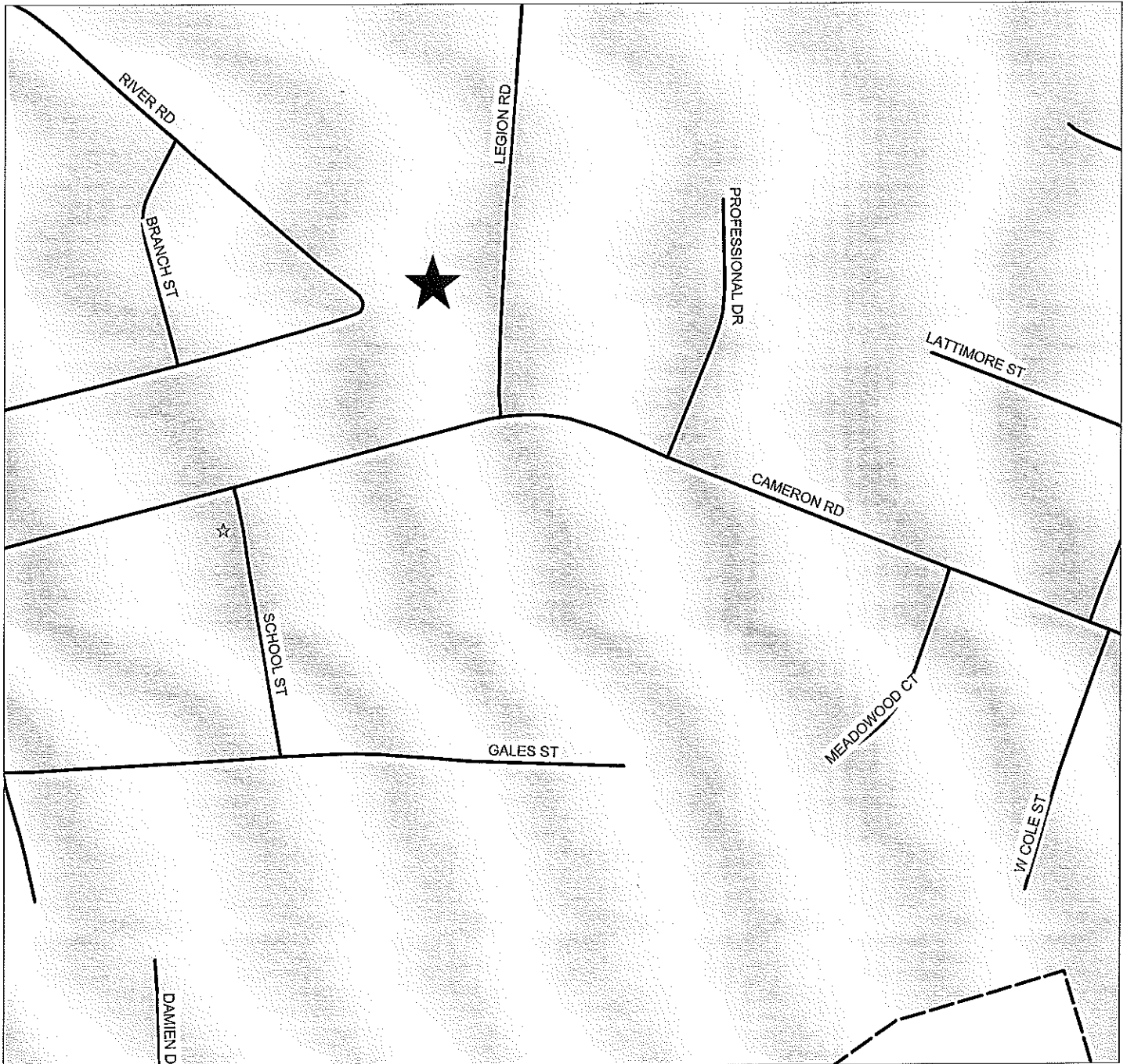

PIN(S): -0414-73-7330-
Created by GJB - EMB
APRIL 21, 2017

Map not to scale



**GADSON GLEN PROPERTY
ZERO LOT LINE SUBDIVISION REVIEW
CASE NO. 16-111**



PIN(S): 0412-54-3178-
Created by GJB - EMB
OCTOBER 7, 2016
Map not to scale



**JOANN HONEYCUT HEIRS PROPERTY
SUBDIVISION REVIEW
CASE NO. 17-052**



PIN(S): -0486-30-1707- & 0485-49-8446-
Created by GJB - EMB
APRIL 17, 2017

Map not to scale



**JAMES & ISABELLA OSTENDORF PROPERTY
SUBDIVISION REVIEW
CASE NO. 17-075**

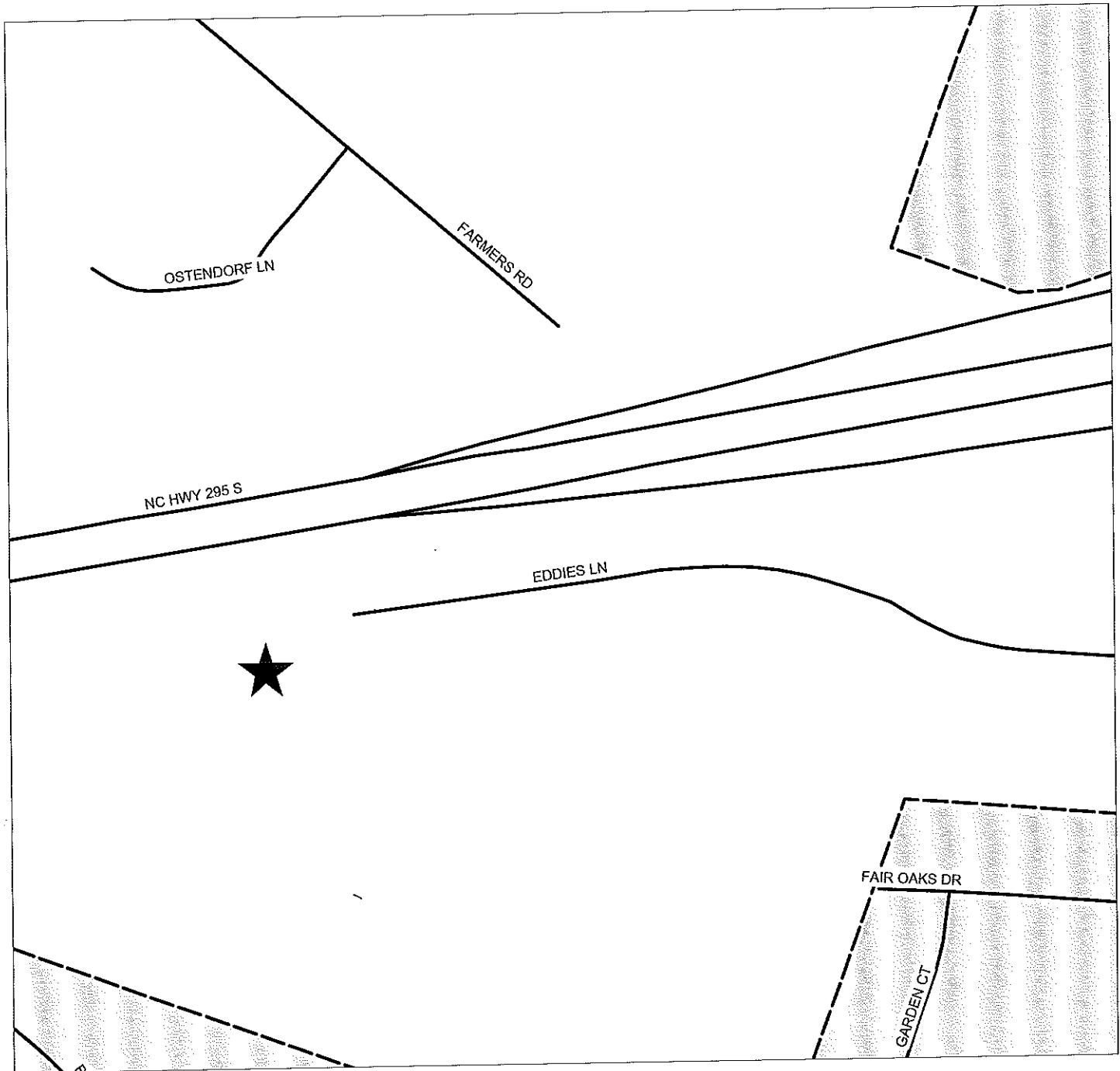

PIN(S): 0531-60-2330-
Created by GJB - EMB
MAY 18, 2017

Map not to scale



**STEPHEN AUTRY PROPERTY
RR SUBDIVISION REVIEW
CASE NO. 17-070**

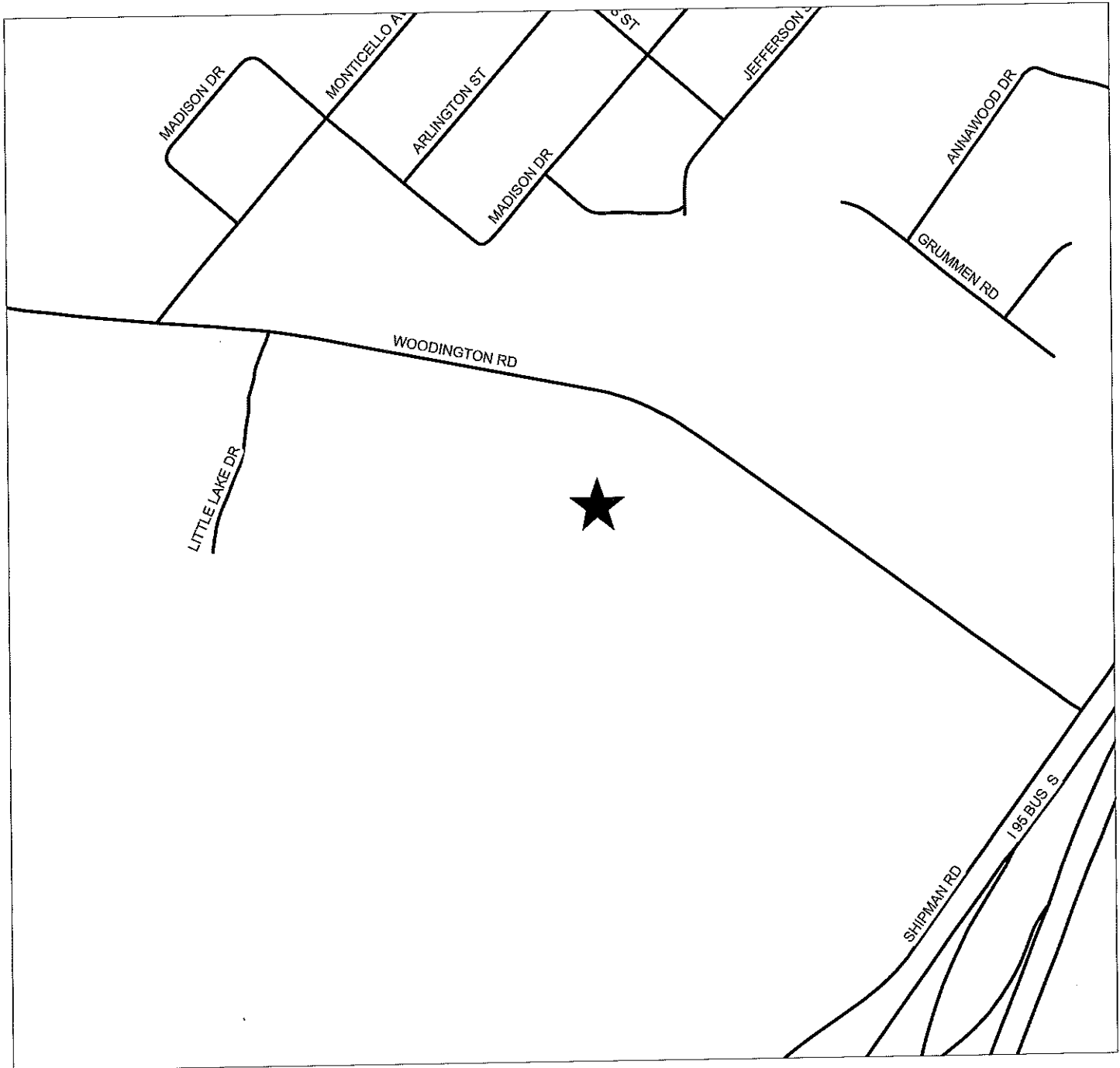

PIN(S): -0413-72-3978-
Created by GJB - EMB
MAY 11, 2017

Map not to scale



**KENNETH LAMM PROPERTY
SUBDIVISION REVIEW
CASE NO. 17-071**

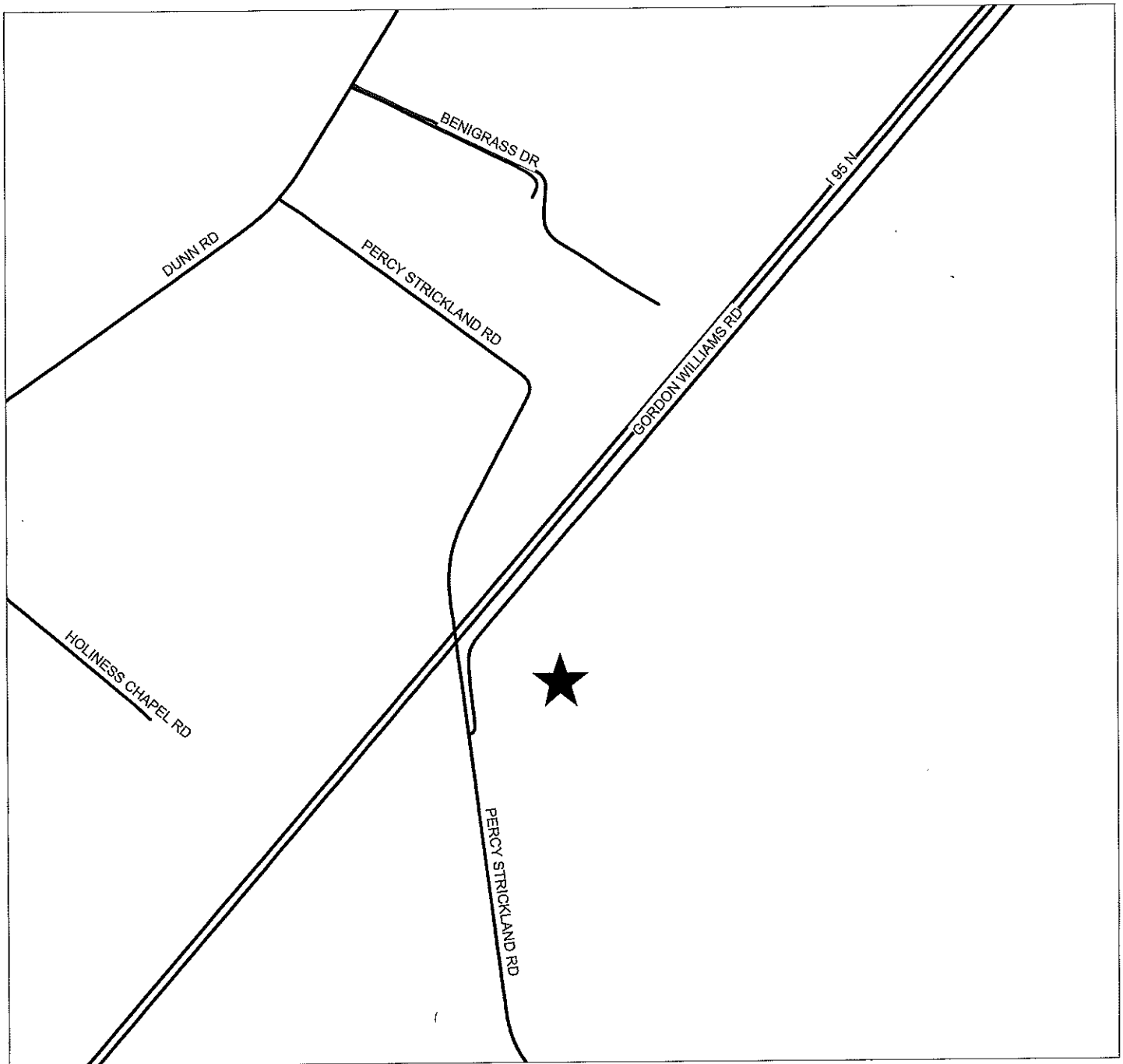

PIN(S): -0591-18-4707-
Created by GJB - EMB
MAY 12, 2017

Map not to scale



**WASTE MANAGEMENT COMPRESSOR COMPOUND RELOCATION
M(P)/AOD SITE PLAN REVIEW
CASE NO. 01-239**



PIN(S): 0433-19-0833- & 0434-00-0278-
Created by GJB - EMB
MAY 18, 2017

Map not to scale



**PRIMERICA FINANCIAL SERVICES PROPERTY
CB/MSOD SITE PLAN REVIEW
CASE NO. 17-066**

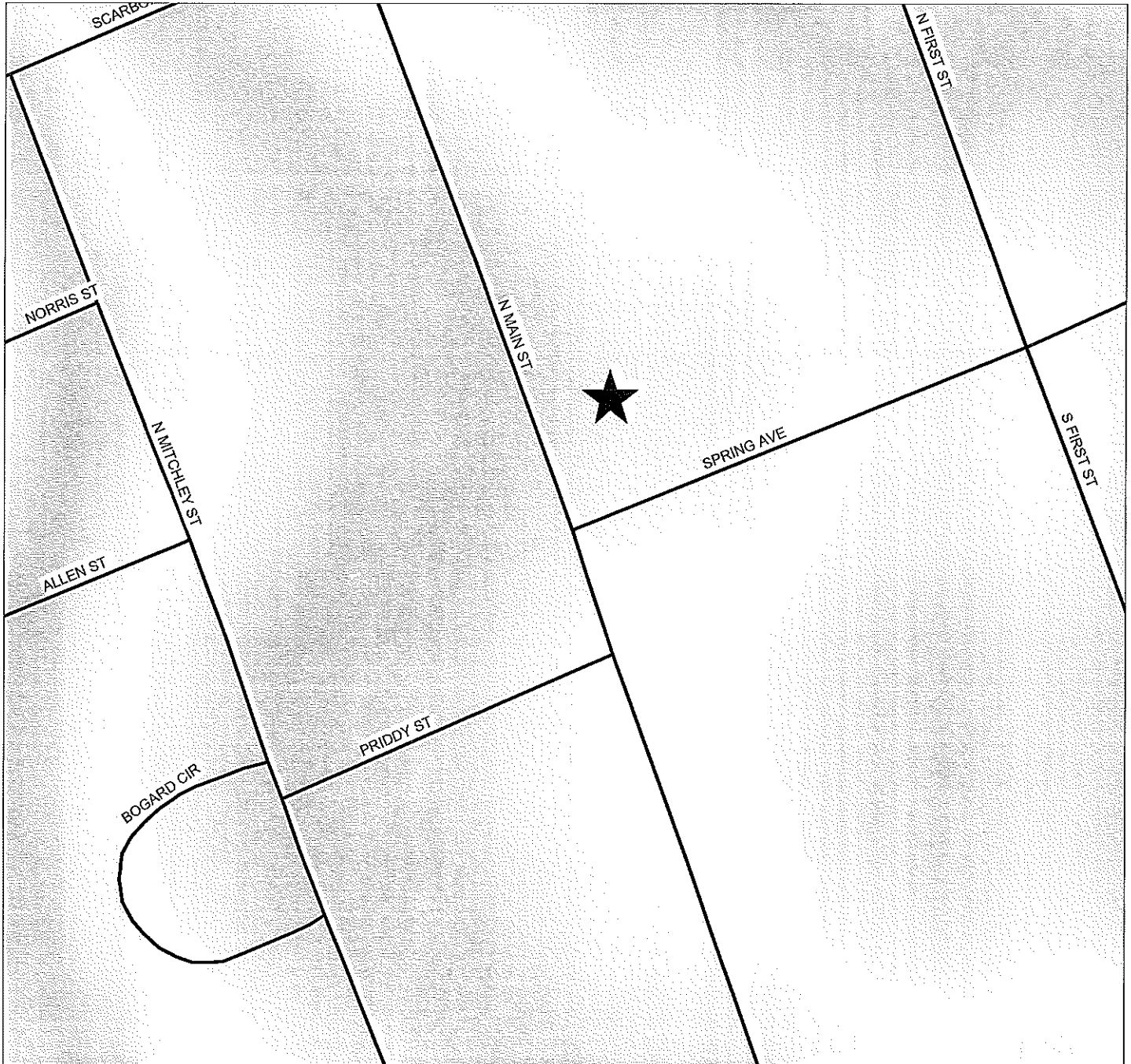

PIN(S): -0561-75-1812-
Created by GJB - EMB
MAY 9, 2017

Map not to scale



**LAW ENFORCEMENT TRAINING CENTER
C(P) SITE PLAN REVIEW
CASE NO. 17-067**

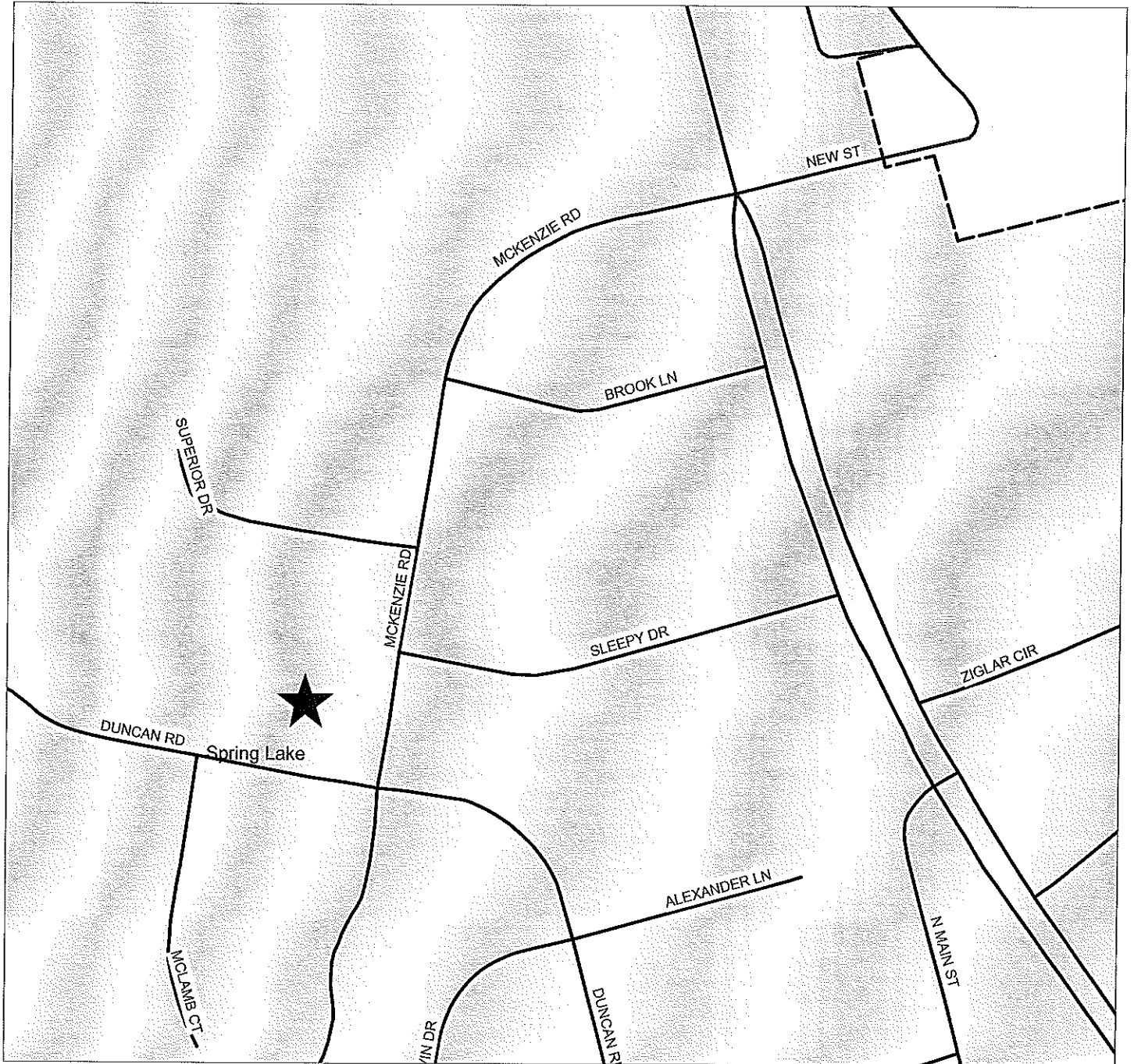

PIN(S): -0501-49-7569-
Created by GJB - EMB
MAY 9, 2017

Map not to scale



**EDGEWOODS FARM SUBDIVISION
SUBDIVISION REVIEW
CASE NO. 17-072**

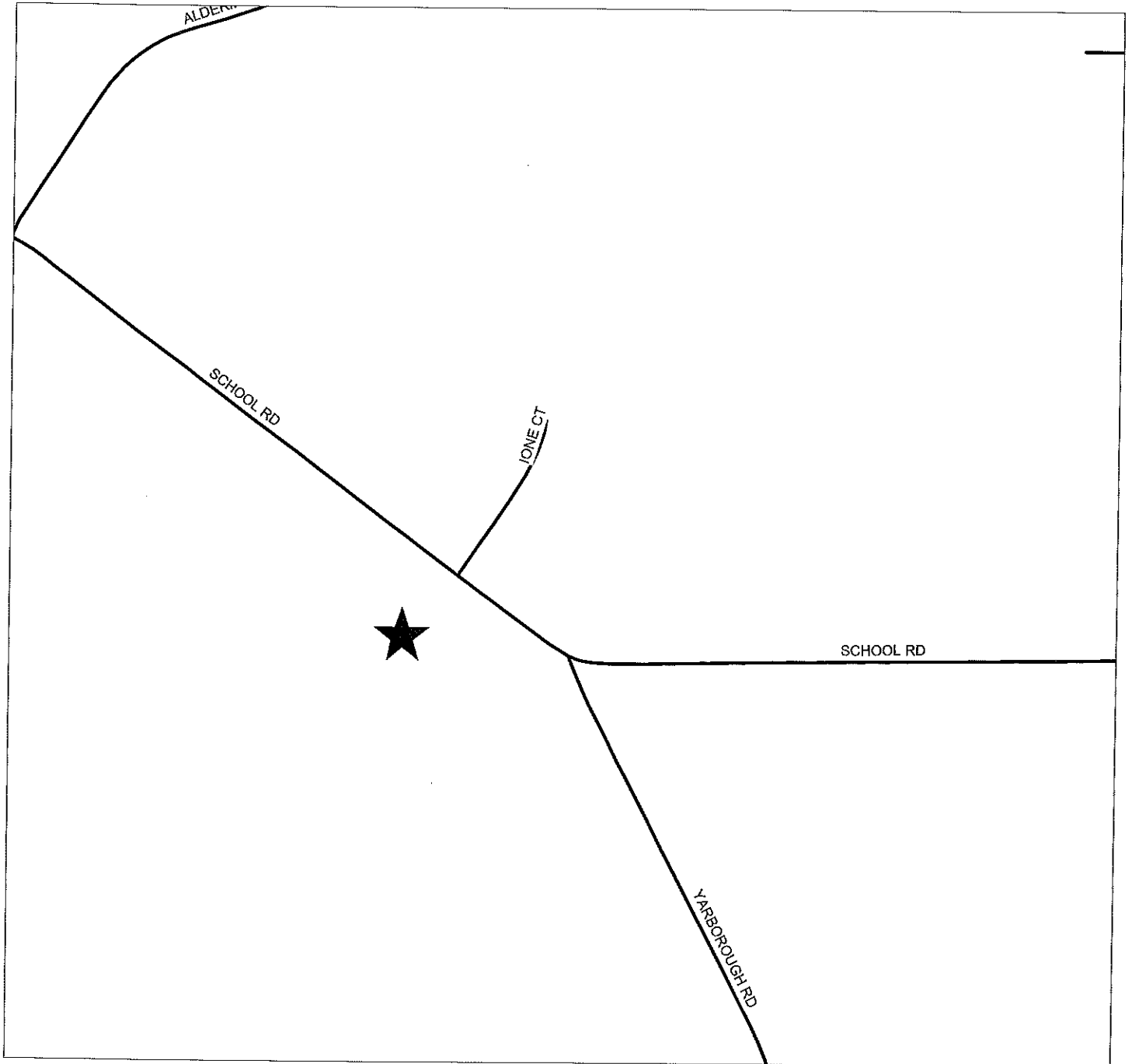

PIN(S): -0441-03-3842-, -04-4622- -04-6475-
Created by GJB - EMB
MAY 12, 2017

Map not to scale



**J FLOYD LEE PROPERTY
SUBDIVISION REVIEW
CASE NO. 17-063**



PIN(S): -00580-98-129- -97-1979- -1850- 2480- 2169-
Created by GJB - EMB
MAY 4, 2017

Map not to scale

